



User Manual  
Release Pro

Rev.04 del 01/04/2021

# User Manual

## Release Pro

Prepared by  
Alterna

## SUMMARY

1	PREMISE.....	3
2	INSTALL RELEASE PRO SETUP .....	4
2.1	Assisted Setup .....	4
3	CONTROL TABLE SETUP – MASTER DATA CONTROL.....	6
3.1	Master data Control .....	6
3.2	Setup a basic control .....	6
3.3	Setup a control with specific filters .....	8
3.4	Setup a control with relation to another table .....	9
3.5	Master data release and block reason code .....	11
4	CONTROL TABLE SETUP – DOCUMENT CONTROL .....	12
4.1	Document Control.....	12
5	CONTROL TABLE SETUP – GENERAL AND ITEM JOURNALS CONTROL .....	13
5.1	General and Item Journals control.....	13
6	APP SUBSCRIPTION.....	13

## 1 PREMISE

This document is a user guide for Release Pro App.

## 2 INSTALL RELEASE PRO SETUP

### 2.1 Assisted Setup

To set controls on the tables, is necessary to enable the ReleasePro extension. Open the Assisted Setup and choose the Release Setup item. The system will open the assisted guide to install the extension.

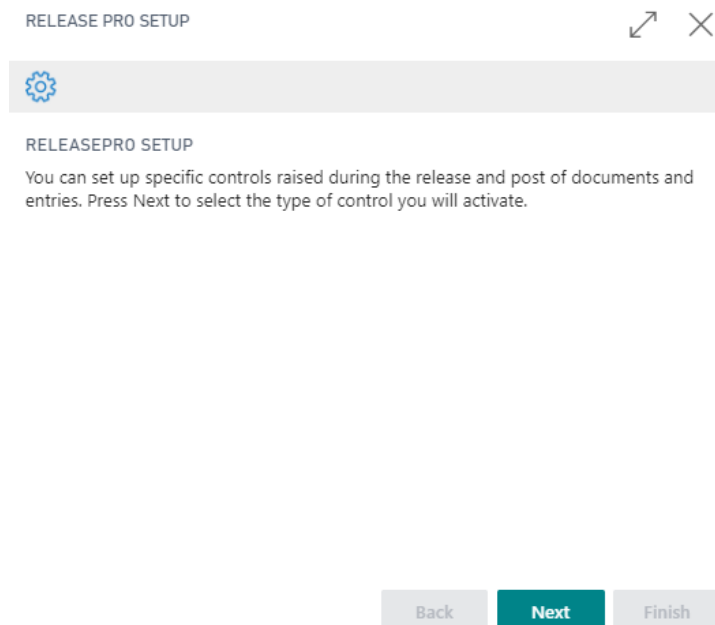

Select the flags for the control to activate.

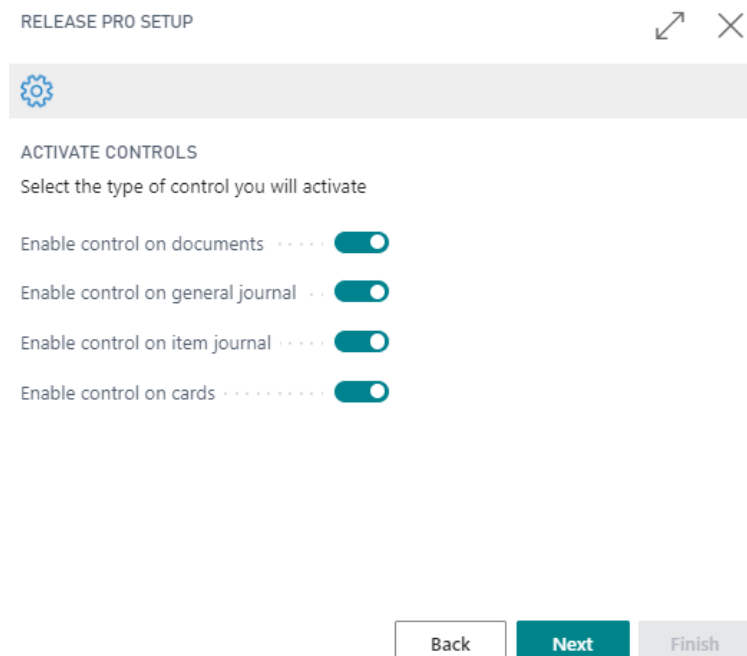

Click Next.

RELEASE PRO SETUP



CONTROL TABLE SETUP

Push Table Setup to configure control table and fields



It is possible to define immediately or later the "Table Setup".

### 3 CONTROL TABLE SETUP – MASTER DATA CONTROL

#### 3.1 Master data Control

To create a control, select “new” from the page *Control Table Setup*.

For example, to create a control on the customer card release it is necessary:

- In the *Table ID* field, click on assist button and will be appear Name/Value lookup. Select the table where apply the control (in this case 18 that is the customer table);

Search

NAME/VALUE LOOKUP

Name	Value
→ Customer	18
Vendor	23
Item	27
Resource	156
Sales Header	36
Sales Line	37
Purchase Header	38
Purchase Line	39
Gen. Jnl. Line	81
Item Jornal Line	83
Transfer Header	5740
Transfer Line	5741

OK Cancel

- The *Table Name* field will be automatically filled in;

CONTROL TABLE SETUP | WORK DATE: 01/04/2019

✓ SAVED

Search	+ New	Edit List	Delete	Show Fields	Open in Excel	Actions	Filter	Menu
TABLE ID	TABLE NAME	DOCUMENT TYPE POS.	DOCUMENT TYPE DESCR.	FIELDS	EN... CO...			
18	Customer	11	All Documents	1				

- In the *Document Type Pos.* and *Document Type Descr.* Select for which type of document apply the control. These fields are necessary only for table related to documents. For master data are automatically filled in with *all documents*.

#### 3.2 Setup a basic control

To set the conditions of the control click on *Show Fields*.  
In the new window it is possible to set the conditions.

CONTROL TABLE SETUP | WORK DATE: 01/04/2019

✓ SAVED



Search	+ New	Edit List	Delete	Show Fields	Open in Excel	Actions	...	Filter	Menu
TABLE ID	TABLE NAME	DOCUMENT TYPE POS.	DOCUMENT TYPE DESCR.	FIELDS	EN... CO...				
18	Customer	11	All Documents	1					

TABLEDATA - 18 | WORK DATE: 01/04/2019

✓ SAVED



## Control Table Detail

Search	+ New	Edit List	Delete	Open in Excel		
FIELD ID	FIELD CAPTION	FIELD VALUE	CONTROL TYPE	CONDITION FILTER		
0			Error			

- In *Field Id* insert the field no. to which apply the control (for example the address);
- The *Field Description* is automatically filled in;
- In *Field Value* fill in the condition that must be verified. Use the filter symbol to set the condition (in the example has been set <>', it means not empty);
- In *Control Type* you can select 3 different options:
  - a) **error**: the system shows an error message and does not release the card;
  - b) **warning**: the system shows a warning message, it is possible to click OK and the card will be released;
  - c) **notification**: the system shows a notification message at the top of the screen.

TABLEDATA - 18 | WORK DATE: 01/04/2019



## Control Table Detail

Search	+ New	Edit List	Delete	Open in Excel		
FIELD ID	FIELD CAPTION	FIELD VALUE	CONTROL TYPE	CONDITION FILTER		
5	Address	<>"	Error			

This is a basic control.

To activate it, go back to the initial page and check *Enable Controls* flag.

Depending on the flow you want to set up, you need to enable the following fields:

- *Enable controls on release*: controls will be executed releasing a card or a document.
- *Enable controls on approval*: controls will be executed sending an approval request for a document, only for tables *Purchase Header*, *Purchase Line*, *Sales Header*, *Sales Line*.

The column *Fields* shows the number of controls set up.

Control Table Setup | Work Date: 01/04/2020

✓ Saved

Search

+ New

Edit List

Delete

Show Fields

Open in Excel

More options

Table ID ↑	Table Name	Document Type Pos.	Document Type Descr.	Fields	Enable controls	Enable controls on approval	Enable controls on release
→ 18	Customer	11	All Documents	1	<input checked="" type="checkbox"/>	<input type="checkbox"/>	<input checked="" type="checkbox"/>

It is possible to enable different controls on different fields at the same time.

In the example the system checks that the address is not empty when a customer card is released and shows an error.

### 3.3 Setup a control with specific filters

Many specific conditions can be set for the controls. For example, opening again the control on customer card, it is possible to set the control to check that the address must be not empty when the country is IT.

To setup this control, open Control table Detail and in *Condition Filter* field select the button with the 3 dots.

TABLEDATA · 18 | WORK DATE: 01/04/2019

✓ SAVED

## Control Table Detail

🔍 Search   + New   📝 Edit List   🗑️ Delete   📄 Open in Excel					
FIELD ID	FIELD CAPTION	FIELD VALUE	CONTROL TYPE	CONDITION FILTER	
5	Address	<>	Error		⋮

In the new window is possible to set the filter:

- In *Field Number* select the field to which apply the filter (in this case Country/Region Code);
- In *Field Filter* enter the filter's value. (In this case the control must be active only for customer with country code IT). Note that it is possible to link multiple filters and use all the classic values (such as "<>", etc. ...).



TABLE FILTERS - + New



FIELD NUMBER	FIELD CAPTION	FIELD FILTER
35	Country/Region Code	IT

OK

Cancel





To complete the setup click OK. In this way a control has been set with a specific filter.  
In this example the system shows an error on the customer card release when the country is IT and the address is empty.

### 3.4 Setup a control with relation to another table

It is also possible to set a conditional control for a field in another table.  
In this example, the unit price of sales order lines must be  $\neq 0$  when the country code of the customer is IT.

Create a basic control as explained in point 3.2 for the unit price on sales line.

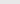
## Control Table Detail

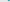
 Search		 New	 Edit List	 Delete	 Open in Excel
FIELD ID		FIELD CAPTION		FIELD VALUE	CONTROL TYPE
	22		Unit Price	<>0	Error

To set the table to which the control is related, select the *Related Tables Conditions* button.

←
TABLEDATA - 18 | WORK DATE: 01/04/2019
✓ SAVED
↗

## Control Table Detail

Search	+ New	Edit List	Delete	Related Tables Conditions	Open in Excel	...	Filter	Menu
--------	-------	-----------	--------	---------------------------	---------------	-----	--------	------

A new window is open:

- in *Condition Table ID* Field, select the related table (in this case customer table);
- In *Condition Filter* field set the filter's field, the procedure is the same as that explained in step 3.3. In this example the condition filter is country = IT.



CONTROL TABLE SETUP | WORK DATE: 01/04/2019

✓ SAVED

TABLE ID	TABLE NAME	DOCUMENT TYPE POS.	DOCUMENT TYPE DESCR.	FIELDS	ENAB... CONT...
37	Sales Line	11	All Documents	1	<input checked="" type="checkbox"/>

### 3.5 Master data release and block reason code

The controls are performed on master data release.

On each master data card there is a new section for Release Pro app with:

- Block reason: it is possible to choose different reason code for block the card;
- Status: open or released like the documents.

#### Release Pro

Block Reason .....  Status ..... Open

It is possible to create a block reason code for each type of master data.

SELECT - BLOCK & DELETE REASON CODE + New

USED BY ▼	CODE	DESCRIPTION	CUSTOMER BLOCK
Customer	BLOCK	Block	All

The new cards are automatically open and Blocked: All.  
The user completes the card and click on button Release.

New Document Request Approval Navigate Customer **Actions** Navigate Report Fewer options

New Document ▼ Request Approval ▼ Workflow ▼ Functions ▼ **Release Pro ▼** Post Cash Receipts... Sales Journal Register Customer Payments

No. .... C00010 ... **Release**  All

The system performs the controls set in control table setup.

Without errors:

- The status is released;
- The Blocked field is empty;
- The card is not editable.

With errors the card remains open and blocked.

It is possible to select a block reason.

In this way the card is blocked also after performing the release.

## 4 CONTROL TABLE SETUP – DOCUMENT CONTROL

### 4.1 Document Control

Open the control table setup page and select a table for sales or purchase documents (such as table 36 - sales headers).

Complete the line in the same way of the previous chapter.

For documents it is possible to choose the *Document Type Pos.*

TABLE ID ▼	TABLE NAME	DOCUMENT TYPE POS.	DOCUMENT TYPE DESCR.
36 ...	Sales Header	11	All Documents

Search Open in Excel

NAME/VALUE LOOKUP

NAME	VALUE
Quote	0
Order	1
Invoice	2
Credit Memo	3
Blanket Order	4
Return Order	5
All Documents	11

OK Cancel

It is possible to select different controls for different types of documents: quotes, orders, etc.

The control is performed when the document is released.

All the other functionalities described in the previous chapter are available also for documents.

## 5 CONTROL TABLE SETUP – GENERAL AND ITEM JOURNALS CONTROL

### 5.1 General and Item Journals control

The ReleasePro setup enables the controls also for Item and General Journals.  
Complete the setup in the same way of the previous chapter.  
The related tables are 81 general journal and 83 item journal.

The control is performed when the document is posted.

←
ITEM JOURNALS | WORK DATE: 01/04/2019
✓ SAVED
↗

Batch Name .....

Manage
Process
Post/Print
Line
Item
Actions
Navigate
Fewer options

Post
Post and Print
Print...

POSTING DATE
ENTRY TYPE
DOCUME... NO.
ITEM NO.
DESCRIPTION
LOCATION CODE
QUANTITY
UNIT OF MEASURE CODE

01/04/2019	:	Positive Adjrr				0	PZ
------------	---	----------------	--	--	--	---	----

All the other functionalities described in the previous chapters are available also for journals.

## 6 APP SUBSCRIPTION

Every App feature requires a valid subscription.

At first installation, a trial plan is automatically activated by the system.

After this period, you can subscribe for a product level (feature) using the Alterna Apps page or directly from the system notifications by clicking on the link which opens the product activation wizard.