

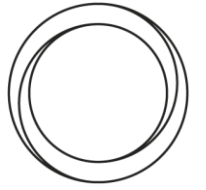

EDGE *Next*

Intelligent Buildings for *people and planet.*

What's next? [↗](#)

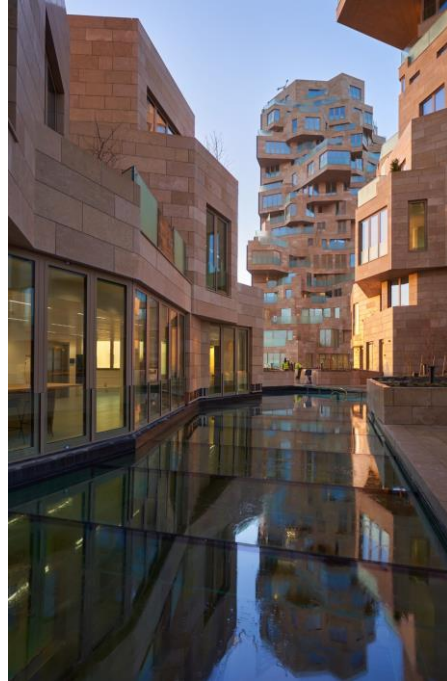

EDGE

Our parent company, EDGE has been developing the most sustainable and innovative real estate for 25 years

What's Next?

EDGE Next Today

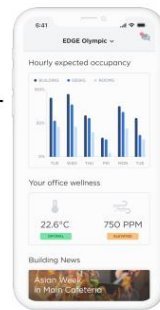

Energy

Monitor your energy and water consumption. Around 70% of climate installations in buildings are not operating correctly, with the potential for saving **up to 30% on energy consumption**.



Wellbeing

Ensure high levels of physical comfort (including temperature and air quality) through rich sensor data. Improving the quality of indoor conditions can lead to an increase in employee productivity and happiness as well as to Fitwel and WELL healthy building certification.



Occupancy

Better exploitation of workplace and meeting room assets in order to **improve your meeting room and desk usage by up to 30%**. Analyse where and how you could improve your cleaning process by up to 20% to boost efficiency and quality while cutting costs.

EDGE Next: Platform

Providing *key insights* across your siloed data for a *single overview* of truth

Management Reports

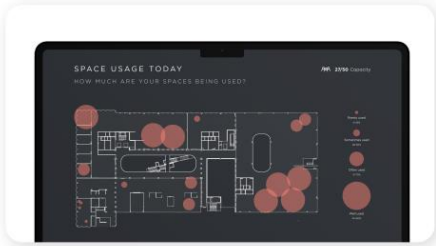
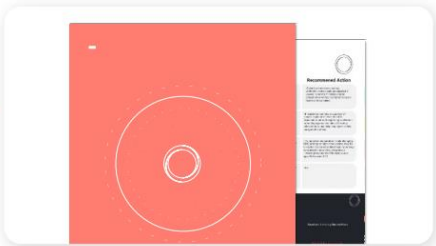

Floor & Room Level Signage

Portfolio Level Dashboards & Insights



Portfolio Management

Employees

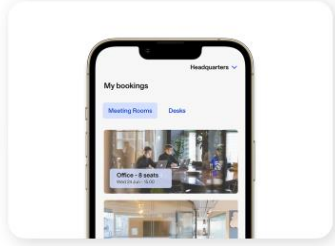

Booking & Employee Engagement App

Detailed Building Level Dashboards & Insights



Facility Operations

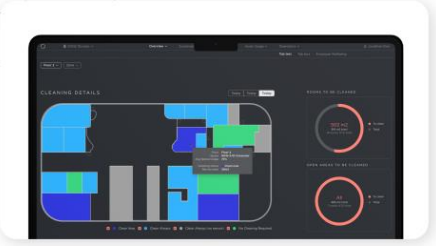

Detailed Building Level Dashboards & Insights

EDGE Next: Microsoft Azure Digital Twin

Secure, future-ready *Intelligent Building* cloud platform

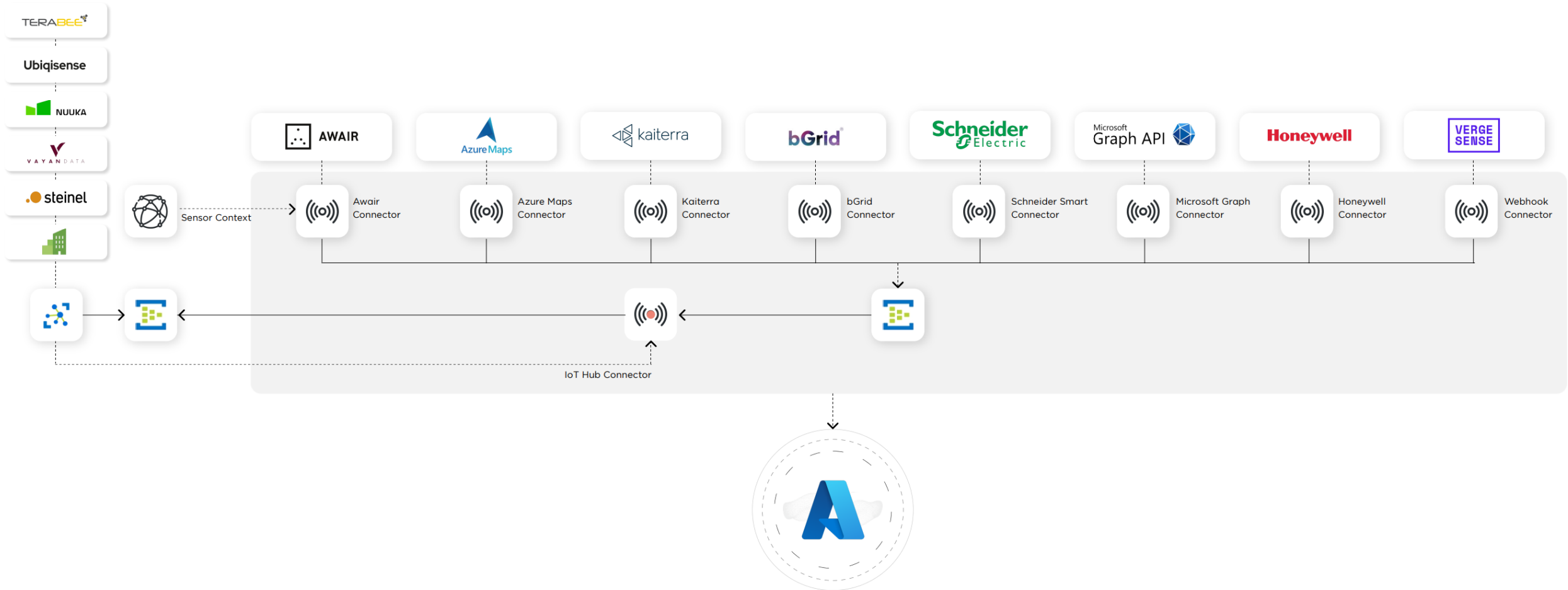
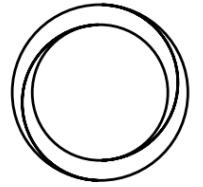

Employee Experience Application Integrations

Integrated intelligent building data into employee experience applications

Reach people when they are making decisions when to come into the office

Guide them to safe spaces where they feel the most comfortable

Inform and guide them to make the most sustainable choices

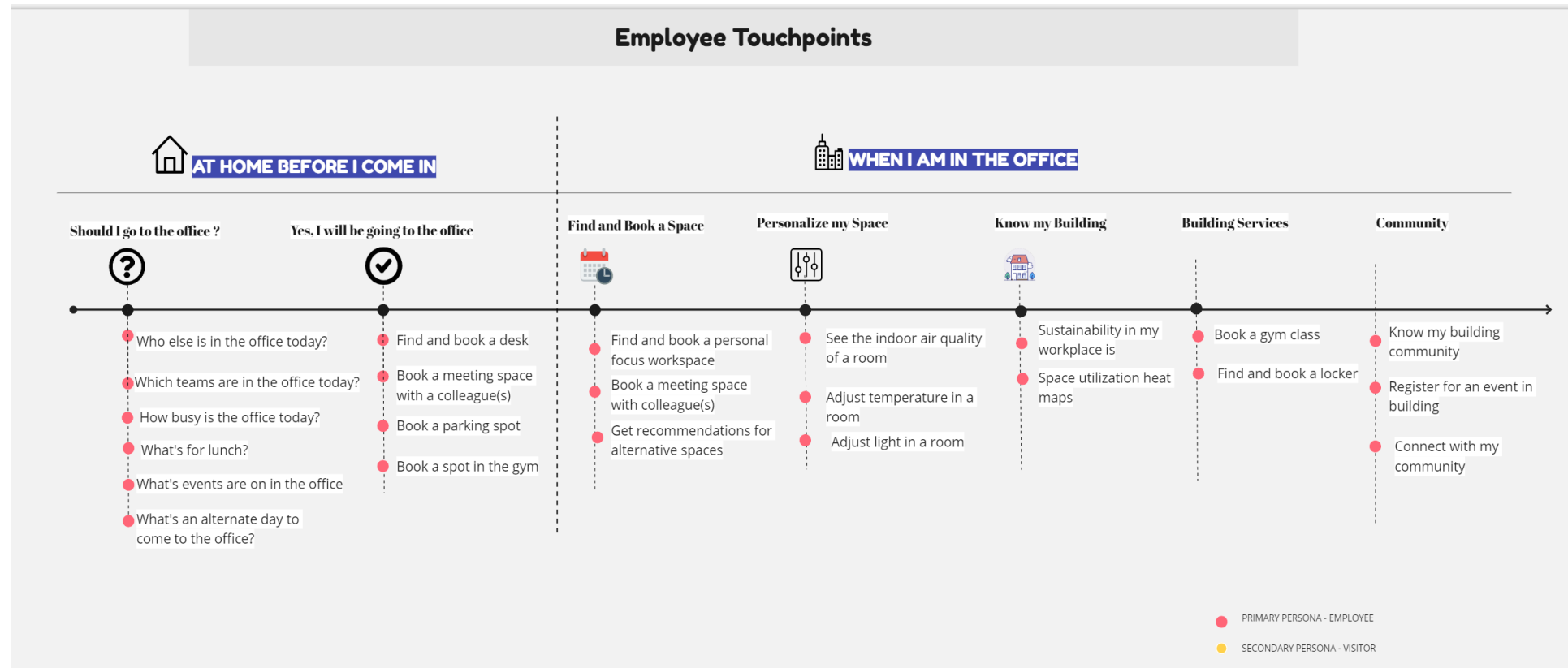
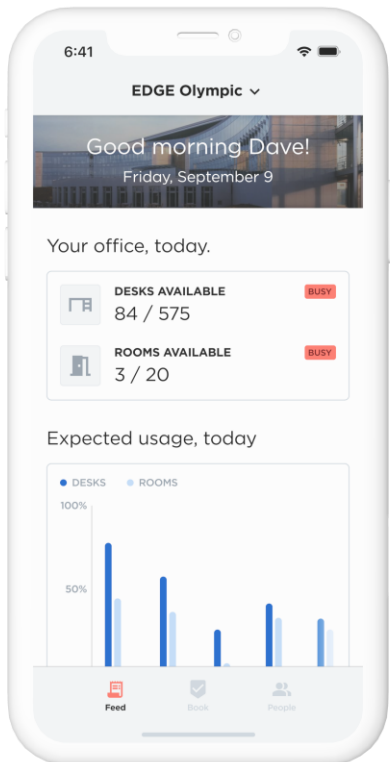

AI Insights

Combining our real estate expertise with data scientists we give you insights to:



Ensure Wellness



Reduce Energy Costs



The dashboard features a top navigation bar with menu items: Overview, Sustainability, Wellbeing, Asset Usage, and Operations. The user profile 'Amit Modi' is visible in the top right. Below the navigation, there are filters for 'Object Types' and 'Select Spaces', along with a refresh icon. On the right, there are date and time filters: 'Last 7 Days' and 'Business hours'. The main content area is titled 'BIOLOGICAL FUNDAMENTALS' and is divided into four sections: 'THERMAL COMFORT', 'SOUND', 'THERMAL COMFORT IN SPACES', and 'SOUND IN SPACES'. The 'THERMAL COMFORT' and 'SOUND' sections each feature a large circular gauge showing a percentage of time in category A (98% for thermal comfort, 77% for sound). A legend below each gauge indicates the distribution of categories: 66% (green), 16% (yellow), 14% (orange), and 4% (red). The 'THERMAL COMFORT IN SPACES' and 'SOUND IN SPACES' sections each contain a table with columns for 'Category', 'Performance incident', and 'Performance trend'. The 'THERMAL COMFORT IN SPACES' table shows categories A, B, and C with performance incidents of 61/93, 15/93, and 13/93 respectively. The 'SOUND IN SPACES' table shows the same categories with the same performance incidents. A 'View more' link is present at the bottom of each of the four main sections. On the left side of the dashboard, a red notification panel is open, displaying four notifications for temperature level too high in various rooms, all with a severity of 'High' and a temperature category of 'D'. A 'Go to all notifications' button is located at the bottom of the notification panel.

NOTIFICATIONS

Mon 4th April 2022, 09:32am
27D51 Multipurpose Room Large, Floor 27
Temperature level too high.
Severity: High ▲
Temperature Category D

Mon 4th April 2022, 11:48am
28A50 Conference Extra Large, Floor 28
Temperature level too high.
Severity: High ▲
Temperature Category D

Mon 4th April 2022, 2:16pm
24B50 Conference Medium, Floor 24
Temperature level too high.
Severity: High ▲
Temperature Category D

Mon 4th April 2022, 3:41pm
27D50 Multipurpose Room Large, Floor 27
Temperature level too high.
Severity: High ▲
Temperature Category D

Mon 4th April 2022, 4:67pm
[Go to all notifications](#)

BIOLOGICAL FUNDAMENTALS

THERMAL COMFORT

98%
of the time in category A

- 66%
- 16%
- 14%
- 4%

[View more](#)

SOUND

77%
of the time in category A

- 66%
- 16%
- 14%
- 4%

[View more](#)

THERMAL COMFORT IN SPACES

Performance trend	Category	Performance incident	Performance trend
61/93	A	61/93	61/93
15/93	B	15/93	15/93
13/93	C	13/93	13/93

SOUND IN SPACES

Performance trend	Category	Performance incident	Performance trend
61/93	A	61/93	61/93
15/93	B	15/93	15/93
13/93	C	13/93	13/93

Basic building onboarding process

Test your use-cases in a pilot and create a model for future roll-outs

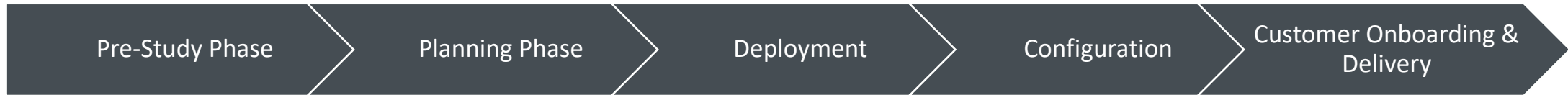
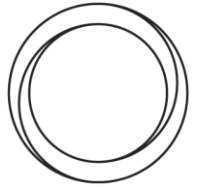

- Technical Pre-Study Complete
- Customer provides all necessary preliminary documentation: floor plan, installations over PoE, ethernet and power sockets

- Development of Deployment plan including Hardware Deployment Strategy based on customer's floorplans & use cases
- Project Kick-Off Meeting

- Delivery of hardware (when applicable)
- Delivery installation manuals and support to client.

- Enabling Customer's unique Signage
- Data validation
- Testing and Quality Assurance

- Onboarding Session to instruct on demoing the product on location

Customer success phase

Customer Pre- Study Complete

Project Kick-Off Meeting

Hardware Installation Complete

Product ready to go live

Product Delivery Meeting Complete



Pre-Study Complete



Project Kick-Off Meeting



Hardware installation complete

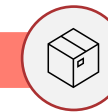

Product Delivery Meeting



Customer Success Handover

Case Study:

40% of Energy Consumption was during nonworking hours.
20% overall energy reduction

Savings of €9 per square meter per year

Insights from the plug loads, lights, screens and heating in the building during all hours, shows significant usage of plug loads, desk screens, light and heating without usage of the building.

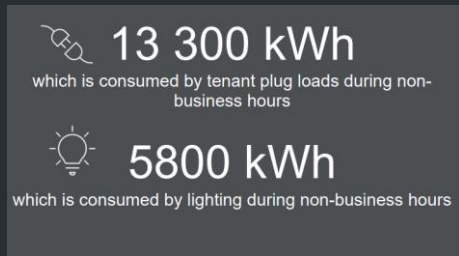
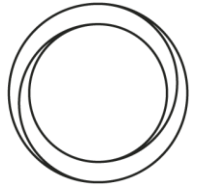

How much energy is consumed?

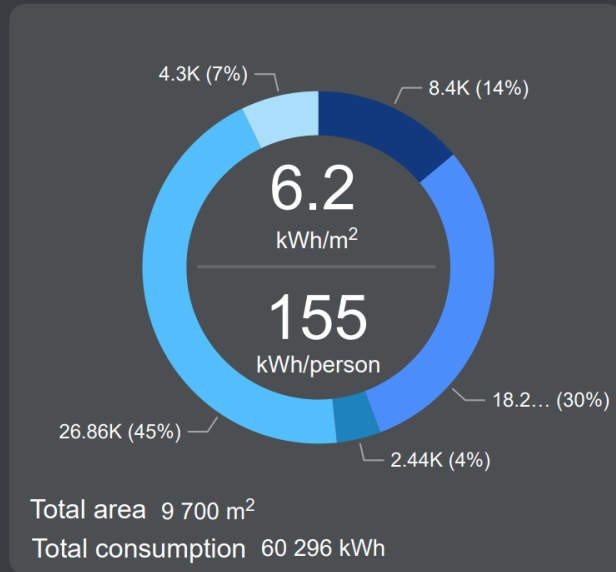

Where is energy consumed?

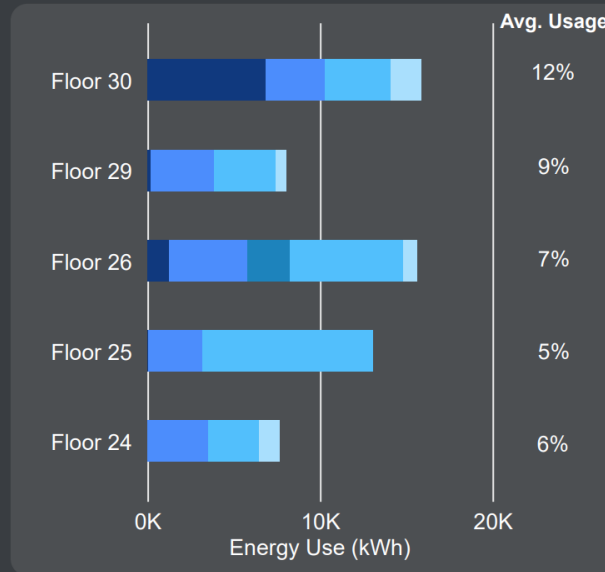

When is energy consumed?

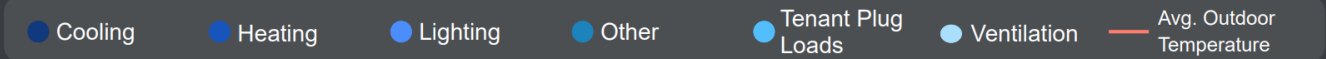
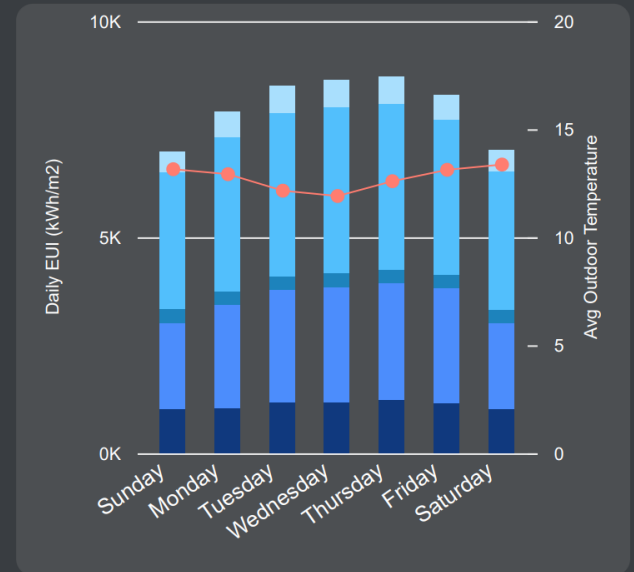

Case Study:

Energy reduction by continuous monitoring

Continuous monitoring of the energy consumption enabled
EDGE Next to find major faults in the HVAC system

Fault detection: Fault detected in the cooling system which caused unnecessary cooling consumption

Solution: Recalibration of the cooling valves

Calculated improvement potential (Jan - April):

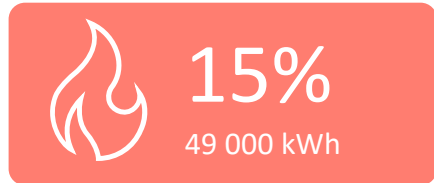

/010

A comparable day before and after deployment of the solution

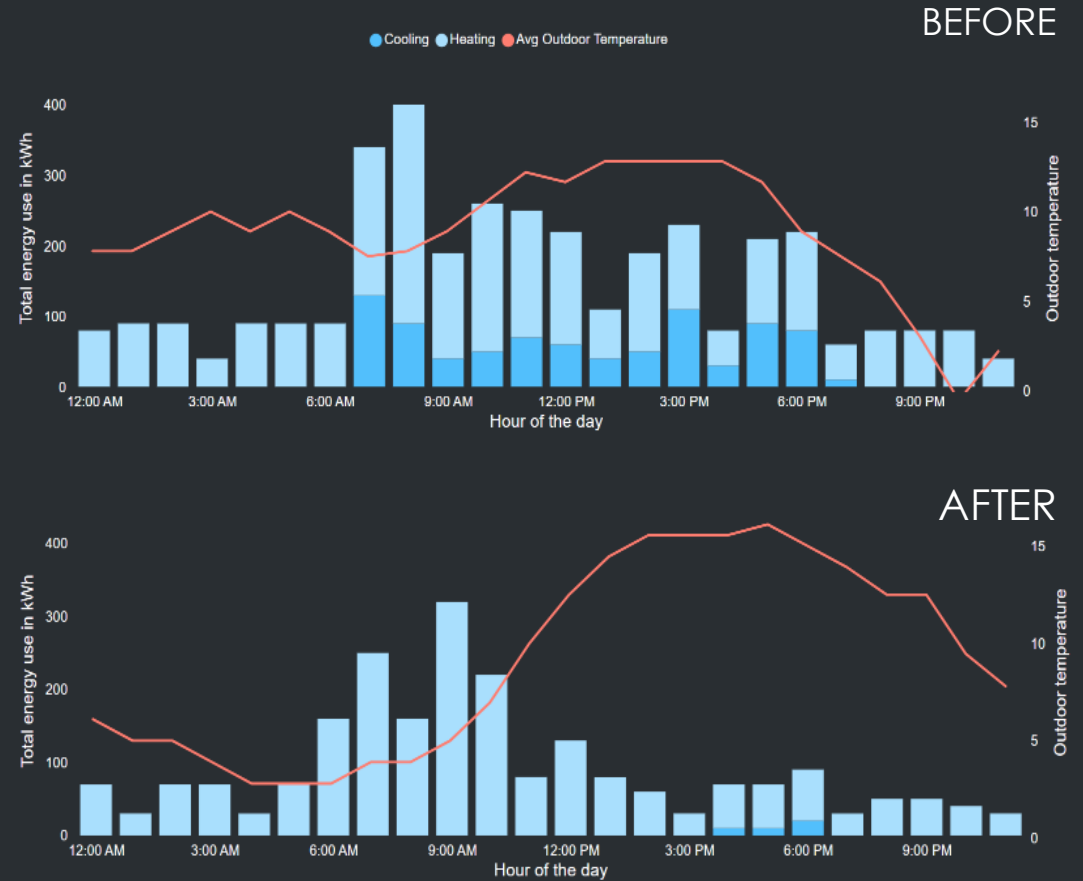

EDGE Next's Customers

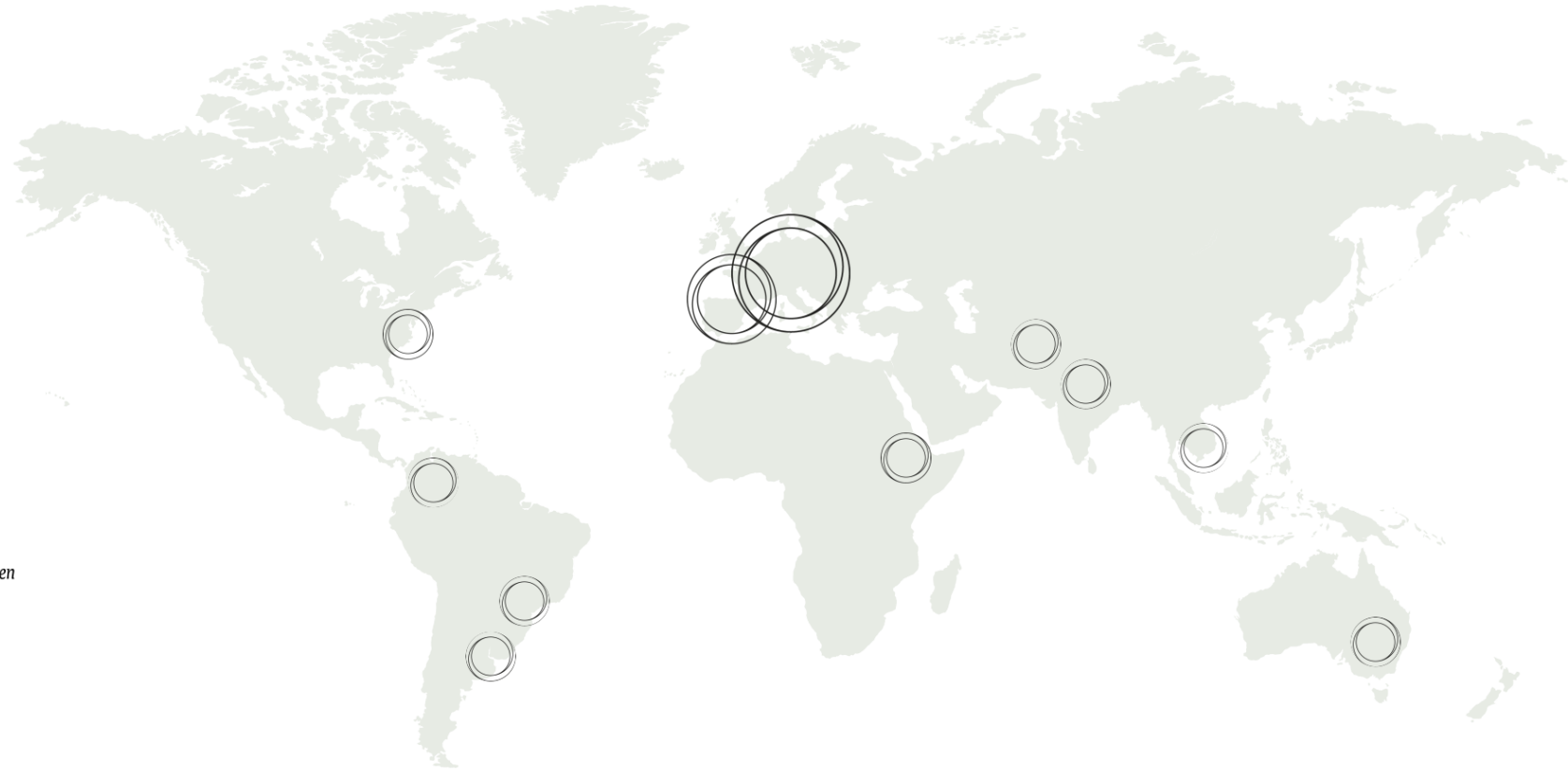



Intelligent Buildings for *people* and *planet*.

Jonathan Wisler

jow@edge-next.com

+31 6 29 45 40 07





Appendix

EDGE Next

EXAMPLE SIGNAGE SCREENS



— Example of a Floor Level Signage (in the lobby of the building for example)

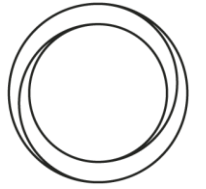

Rooms that are fresh and available for you to use

We show you which rooms are available for an ad-hoc meeting or to work individually.

Find a workspace that has been sufficiently refreshed for an optimal and productive environment.

WHERE CAN I FIND A SPACE TO COLLABORATE?

27/50 Capacity

AVAILABLE	ROOM NAME	AIR QUALITY	CAPACITY
✓	Boardroom 2	Great ●	6
✓	C Living Room	Great ●	4
✓	Cinema	Great ●	80
✓	C-Level	OK ●	4
✓	Room 4.1	Great ●	6
✓	HR Room	Great ●	4
✓	Office for a day 1	Good ●	2
✗	Office for a day 2	Let it ventilate ●	1
✗	Library	Good ●	9
✗	Room 4.2	Great ●	15
✗	Room 4.3	Great ●	6

WELL VENTILATED ROOMS AVAILABLE FOR YOUR USE

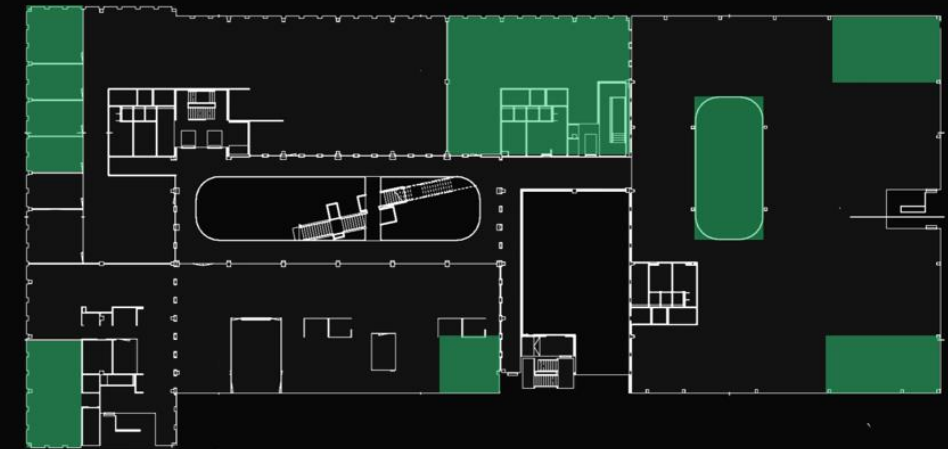

● Well ventilated and available

09:30 AM | Last updated one minute ago



Rooms that are fresh and available for you to use

We show you which rooms are available for an ad-hoc meeting or to work individually.

Find a workspace that has been sufficiently refreshed for an optimal and productive environment.

WHERE CAN I FIND A SPACE TO COLLABORATE?

AVAILABLE	ROOM NAME	AIR QUALITY	CAPACITY
●	Boardroom 2	Good ●	2-6
●	C Living Room	Good ●	2-4
●	Cinema	Good ●	2-30
●	C-Level	OK ●	2-4
●	Room 41	Good ●	2-6
●	HR Room	Good ●	2-4
●	Office for a day 1	Good ●	2-7
●	Office for a day 2	Let's work: 20 ●	2-1
●	Library	Good ●	2-8
●	Room 42	Good ●	2-5
●	Room 43	Good ●	2-6

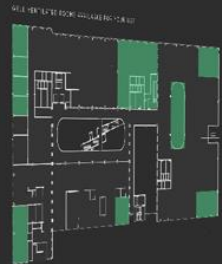

Example of a room level signage (in front of a meeting for example)

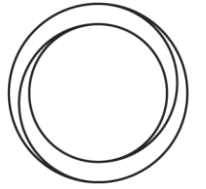

Signage

EDGE Next has a signage solution delivering real-time data for a specific room, area or floor. Examples are desk occupancy, room occupancy as well as air quality (e.g. CO2 levels) in the room, notifying employees when air quality is not optimal.

next **Room 4.4** Room is mainly in Category **A**

Ventilation

Did you know that fresh air and high amounts of ventilation are key for your health and ability to be at your best?

This room allows you to perform at **100%** of your optimum level.

CO2 Level 900ppm

09:30 AM *Last updated one minute ago Powered by Edge NEXT

next **Room 4.4**

1800ppm CO2 Level

Current Air Quality

CO2 levels are too high. Take a coffee break so the room can refresh.

COVID-19 safe levels
Below > 1200ppm

09:30 AM *Last updated one minute ago Powered by Edge NEXT



Appendix

EDGE Next

EXAMPLE PORTAL DASHBOARDS





Last 7 days

Business Hours

PORTFOLIO OVERVIEW

A-Z (Alphabetical)

List View

Map View

Graph View



[View more](#)

EDGE OLYMPIC

Amsterdam, Netherlands

#1 of 4
for Energy
in the portfolio

#1 of 4
for Space Usage
in the portfolio

#3 of 4
for Air Quality
in the portfolio

#1 of 4
for Temperature
in the portfolio

EXPAND +



[View more](#)

EDGE TECHNOLOGIES AMSTERDAM

Amsterdam, Netherlands

N/A of 4
for Energy
in the portfolio

#3 of 4
for Space Usage
in the portfolio

#1 of 4
for Air Quality
in the portfolio

#2 of 4
for Temperature
in the portfolio

EXPAND +



[View more](#)

EDGE TECHNOLOGIES BERLIN

Berlin, Germany

N/A of 4
for Energy
in the portfolio

#2 of 4
for Space Usage
in the portfolio

#2 of 4
for Air Quality
in the portfolio

#3 of 4
for Temperature
in the portfolio

EXPAND +

BEST PERFORMANCE

EDGE TECHNOLOGIES AMSTERDAM
Amsterdam, Netherlands

has the best Air Quality performance

10%
more than portfolio average 96%



LOWEST PERFORMANCE

EDGE TECHNOLOGIES HAMBURG
Hamburg, Germany

has the lowest Air Quality performance

-19%
less than portfolio average 96%



TODAY IN MY BUILDING

PERFORMANCE BY MODULE

[View more](#)



SPACE USAGE BY SPACE TYPE

[View more](#)

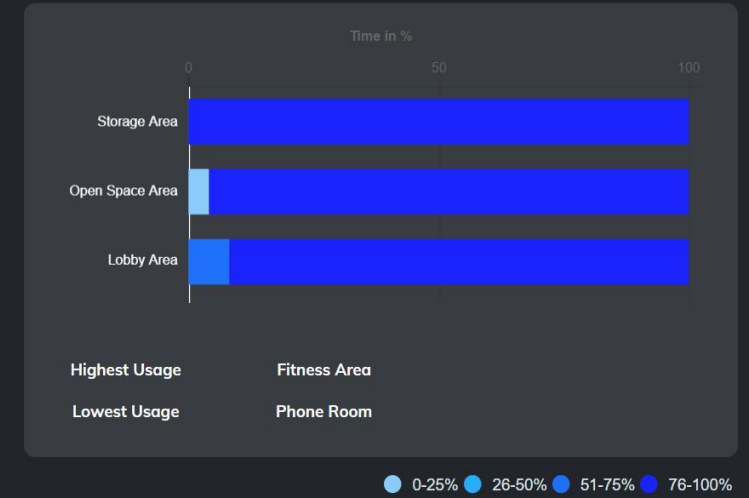

SPACE USAGE (AVERAGE)

[View more](#)

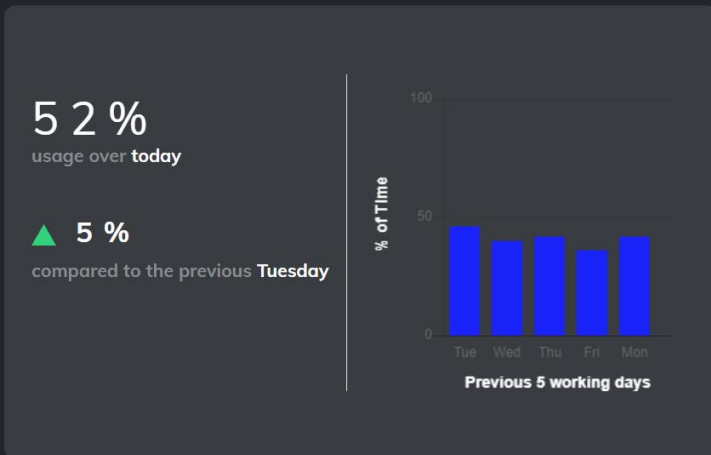

CURRENT WEATHER



WELLBEING

[View more](#)

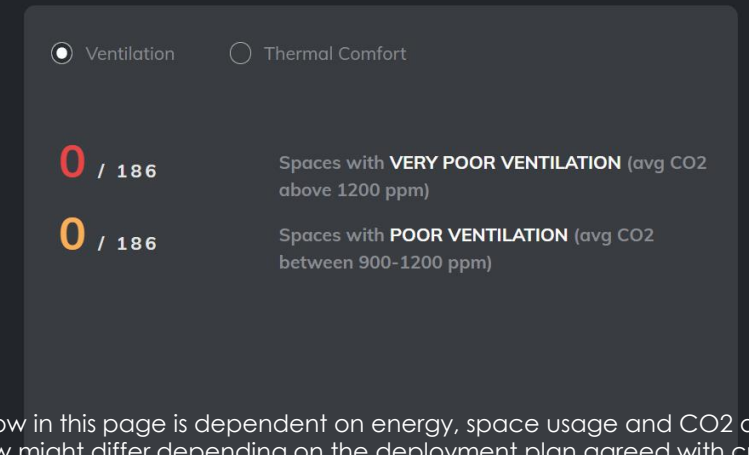

Disclaimer: The data show in this page is dependent on energy, space usage and CO2 data. Thus, the view might differ depending on the deployment plan agreed with customer.

ENERGY OVERVIEW

ENERGY CONSUMPTION FORECAST ⓘ

Click each marker to see forecast EUI and CUI

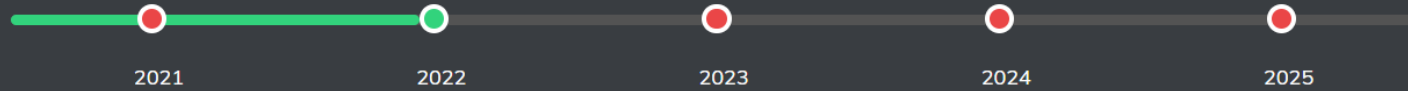

2022 - Forecast

 **EUI**
(Energy Use Intensity)
130.24 kWh/m²

 **Carbon Intensity**
36.56 kg/m²

ENERGY BY SOURCE ⓘ



- District
- Electric
- Energy Generated

[View more](#)

ENERGY BY USE ⓘ





- Electricity
- Cooling
- Heating

[View more](#)

CARBON FOOTPRINT

Your current energy consumption, is the equivalent of the following:

 **27**
Households

 **3728**
Trees

 **25**
Per
Capita

 **224**
Tonnes



Floors Zones Refresh

Last 31 days All Hours

Back

ENERGY CONSUMPTION BY USE

Energy By Source Energy By Use

COMPARE WITH

- Space Usage
- Outdoor Temperature

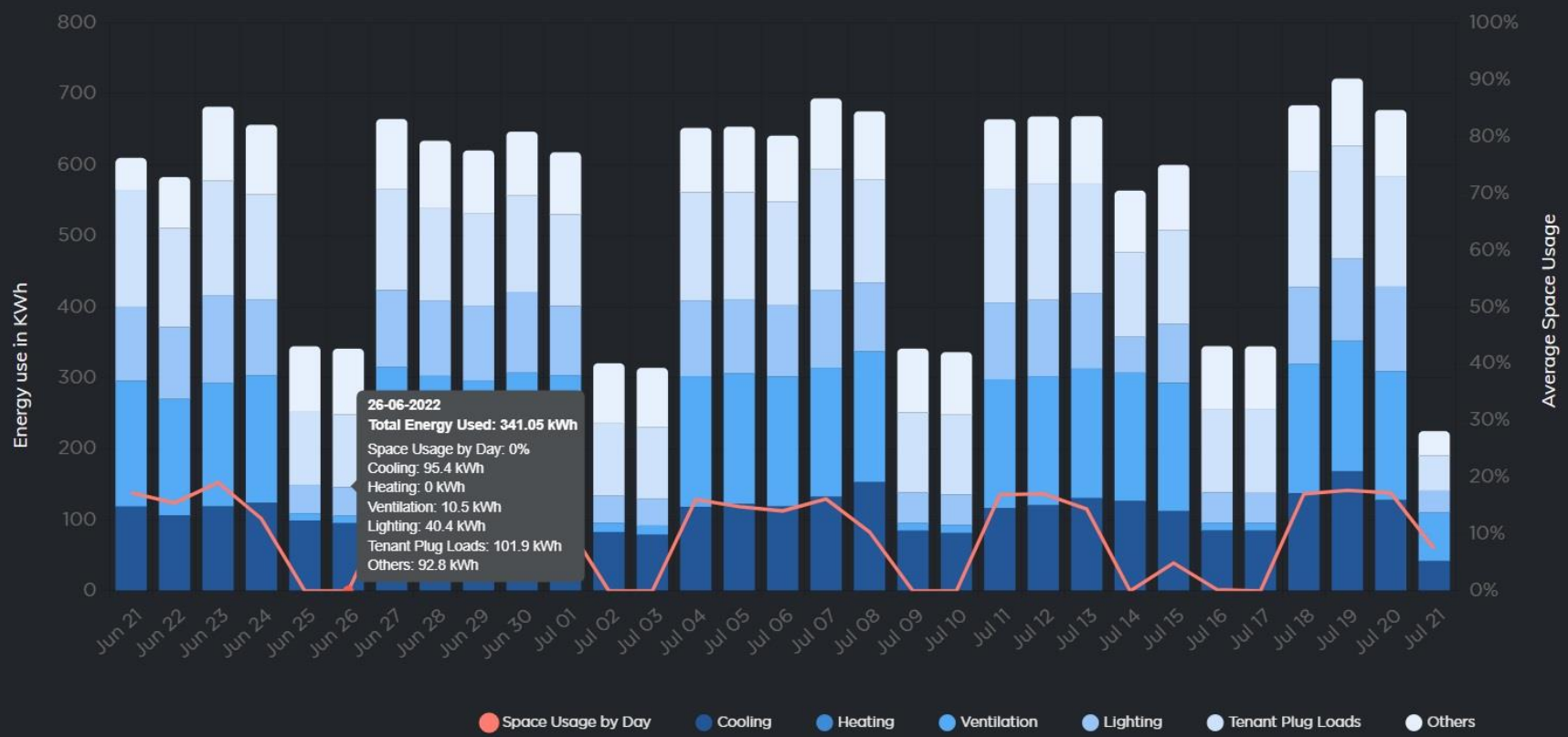

Disclaimer: 1. Space usage line will be shown only if customer has space usage sensors deployed (occupied? yes/no data)
 2. The Types of usage (Heating, Cooling, Electricity) differs per building installations.



Floors Types Refresh

Last 7 days Business Hours

BIOLOGICAL FUNDAMENTALS

VENTILATION (CO2)

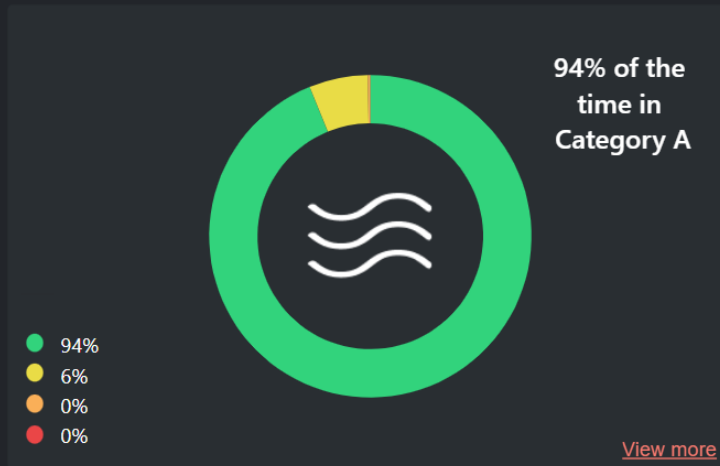

PERFORMANCE OVER LAST SEVEN DAYS

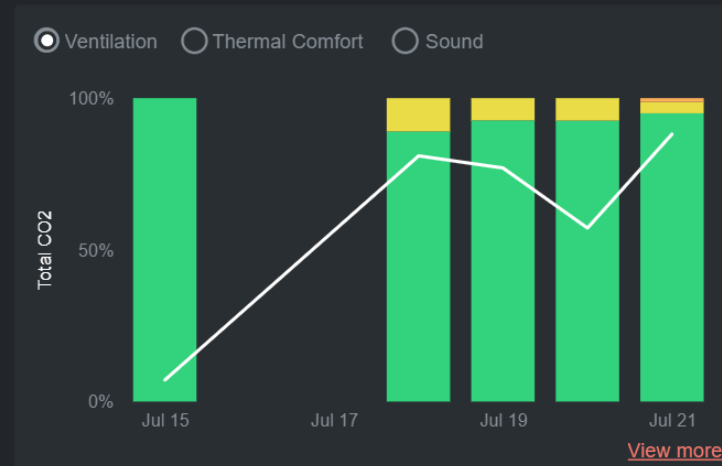

LOW PERFORMING SPACES

Ventilation

Category	Performance Incident	Performance Trend
C	12/82	0/82
D	3/82	0/82

Thermal Comfort

Category	Performance Incident	Performance Trend
C	20/114	2/114
D	5/114	1/114

Sound

Category	Performance Incident	Performance Trend
C	2/114	1/114
D	0/114	0/114

THERMAL COMFORT

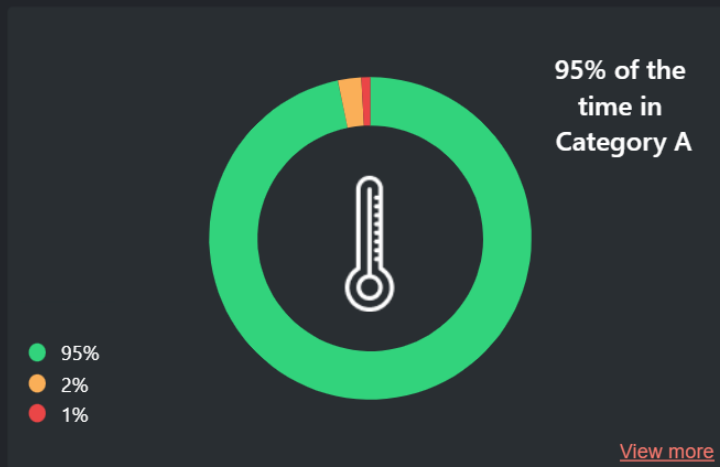

SOUND

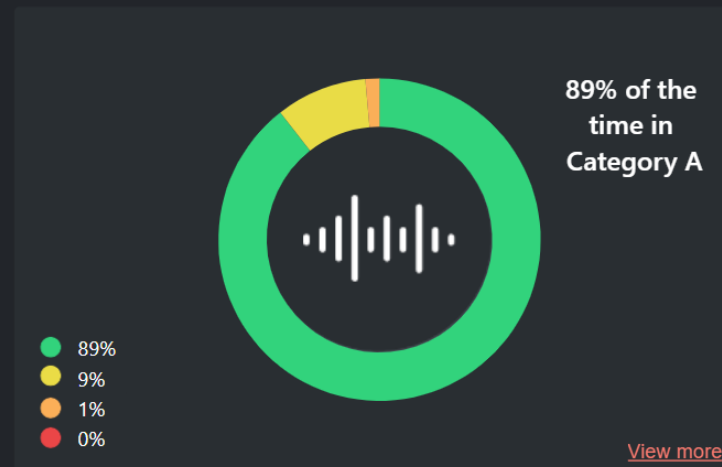

● Category A ● Category B ● Category C ● Category D



Floors

Types

Spaces



Last 7 days

Business Hours

Back

VENTILATION PULSE CHECK

VENTILATION PERFORMANCE

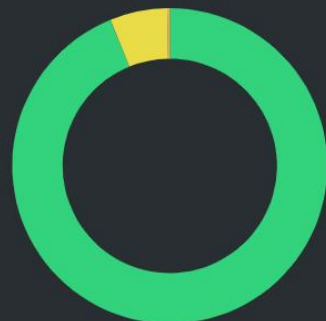
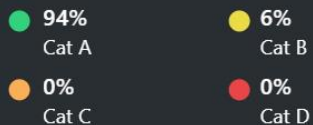

94%

Of the time the CO2 level was in Category A

[View more](#)

VENTILATION IN SPACES

Category	Performance Incident	Performance Trend
A	51/82	82/82
B	16/82	0/82
C	12/82	0/82
D	3/82	0/82

82/82 Spaces with **VERY GOOD VENTILATION** (Avg CO2 below 750 ppm)

0/82 Spaces with **GOOD VENTILATION** (Avg CO2 below 900 ppm)

0/82 Spaces with **AVERAGE VENTILATION** (Avg CO2 below 1200 ppm)

0/82 Spaces with **POOR VENTILATION** (Avg CO2 above 1200 ppm)

ABILITY TO PERFORM BASED ON CO2



100%

productivity levels in the last 5 days

VENTILATION

By Day By Floor By Space Type

[View more](#)

Day	Peak CO2 (ppm)	Lowest CO2 (ppm)	CO2 levels over time in %
Monday	1664	390	89% Cat A, 11% Cat B, 0% Cat C, 0% Cat D
Tuesday	1142	388	93% Cat A, 7% Cat B, 0% Cat C, 0% Cat D
Wednesday	1208	313	93% Cat A, 7% Cat B, 0% Cat C, 0% Cat D
Thursday	1062	275	95% Cat A, 4% Cat B, 1% Cat C, 0% Cat D
Friday	1031	380	100% Cat A, 0% Cat B, 0% Cat C, 0% Cat D



← Back

Thermal Comfort details

Calendar

Graph view

Floor Plan

Table

From 04/06/2022 to 26/06/2022

SPACES

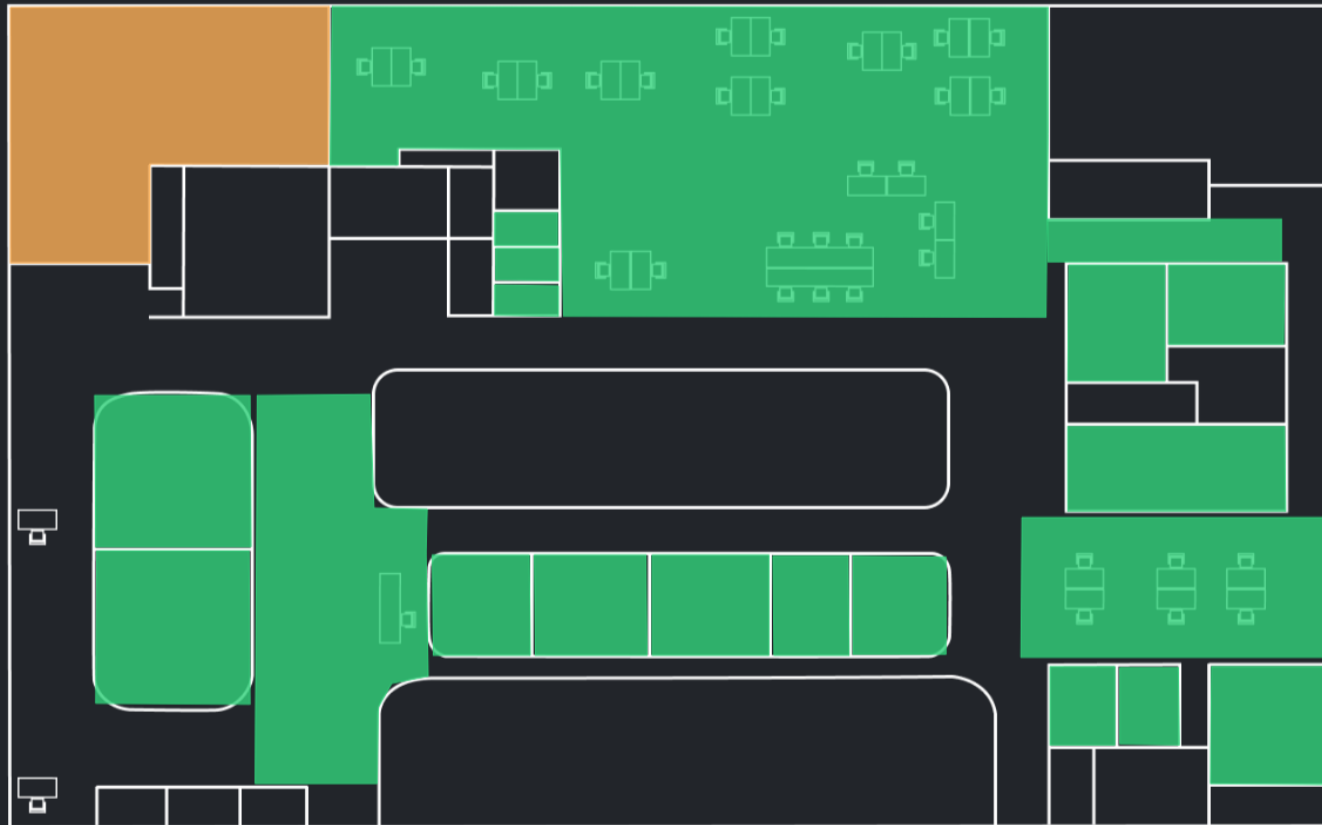

PEAK TEMPERATURE

27 °C

The highest temperature was measured in PANTRY XL ON FOURTH FLOOR ON FRI JUN 17 AT 18:00

THERMAL COMFORT PERFORMANCE

87%

of the time the Temperature level was in Category A

THERMAL COMFORT COMPARISON

▲ 11%

more in **Category A** than in the previous period



Floors Types Refresh

Last 31 days Business Hours

SPACE USAGE PULSE CHECK

BUSIEST DAY

Tuesday



With an average usage of 49%

[View more](#)

AVERAGE

44%

usage during the selected period

28% ▲

compared to the previous period

[View more](#)

SPACE USAGE

By Day By Floor By Space Type

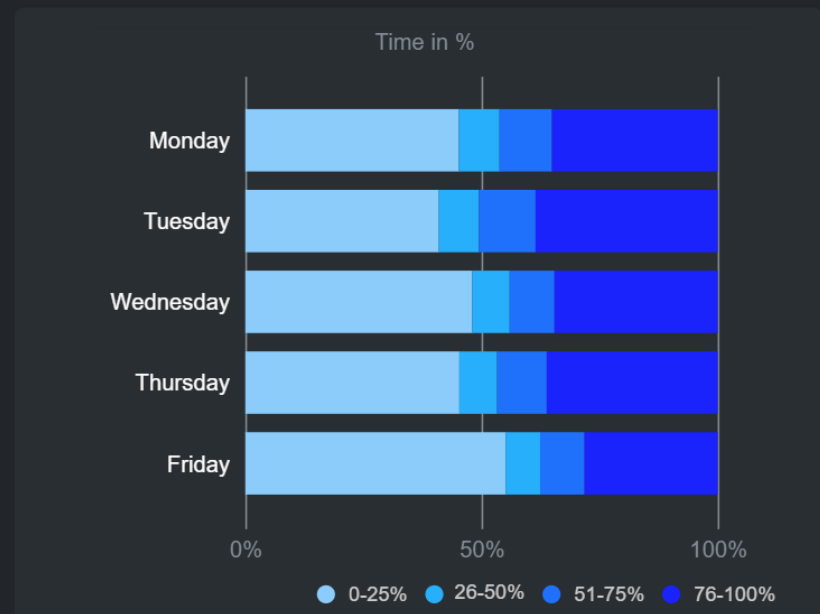

Highest usage Tuesday

Lowest usage Friday

[View more](#)

MOST POPULAR ROOMS

[View more](#)

Room	Space Usage (in %)	Change
Private Office 1.1	92%	▲ +56%
Studio 009	81%	▲ +65%
Studio 107	80%	▲ +56%
Private Office 2.3	79%	▲ +51%
Studio 001	79%	▲ +58%

LEAST POPULAR ROOMS

[View more](#)

Room	Space Usage (in %)	Change
Studio 108	8%	▲ +6%
Studio 310	8%	▲ +5%
Private Meeting Room 2.6A	10%	▲ +4%
Studio 109	11%	▲ +7%
Studio 308	13%	▲ +7%

First Floor ▾

Types ▾



CLEANING DETAILS

Floor Plan

Table View

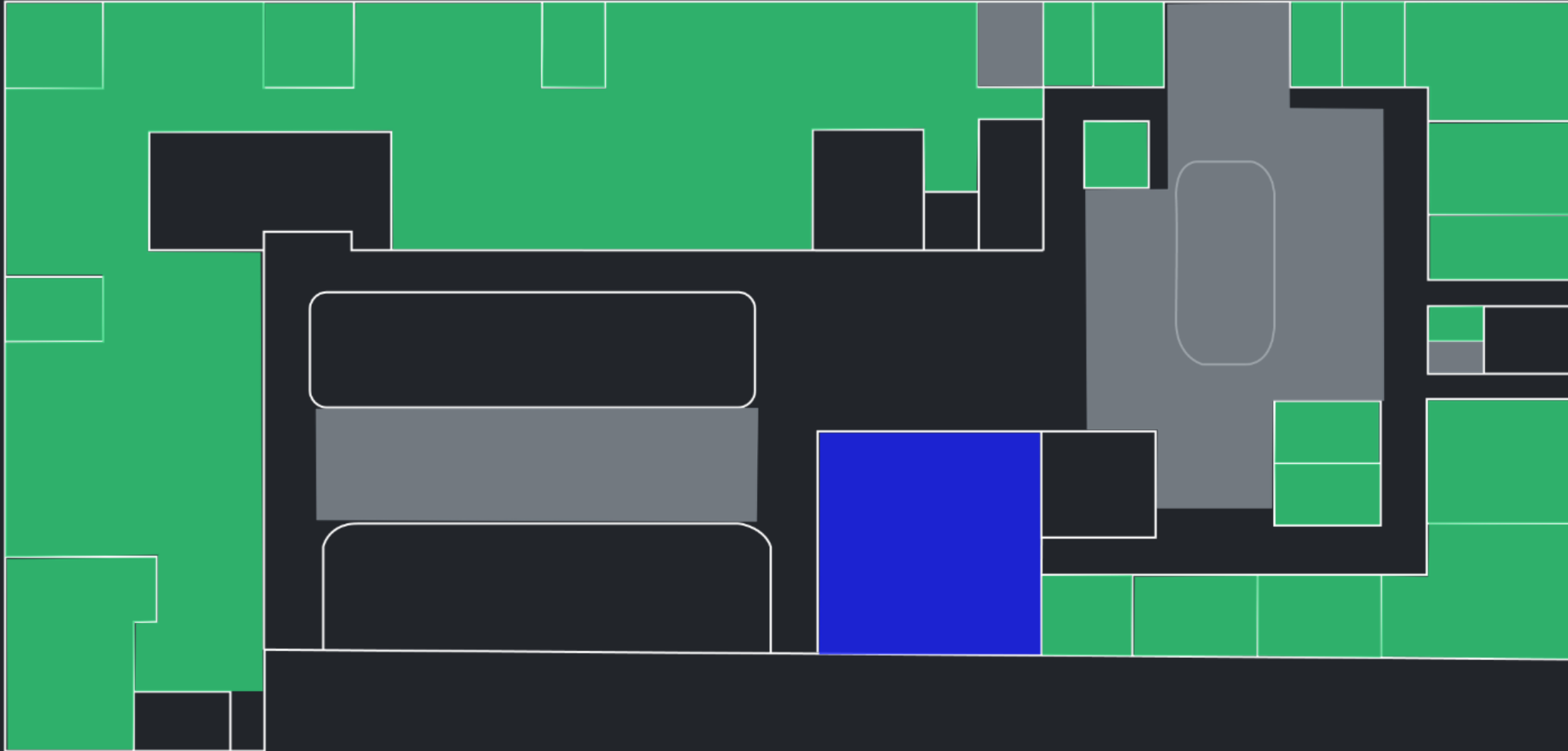

● Clean Now ● Clean Always ● Clean Always (no sensors) ● No Cleaning Required