



# The Future of Autonomous Retail

**IIIIROBOTICS**

# We are unlocking a new world of retail

Our technology is the enabler for a new kind of retail: autonomous, frictionless and personal.

We make **AI-driven autonomous stores** that completely transform the shopping journey.





# 1MRobotics autonomous stores

Robotics wrapped in an immersive user experience.

24/7, omnichannel, zero labor, and highly secure. Exciting new ways of interaction.

# Use Cases



**FOR URBAN AUTONOMOUS STORES**



## STORE-ADJACENT AUTONOMOUS STORES

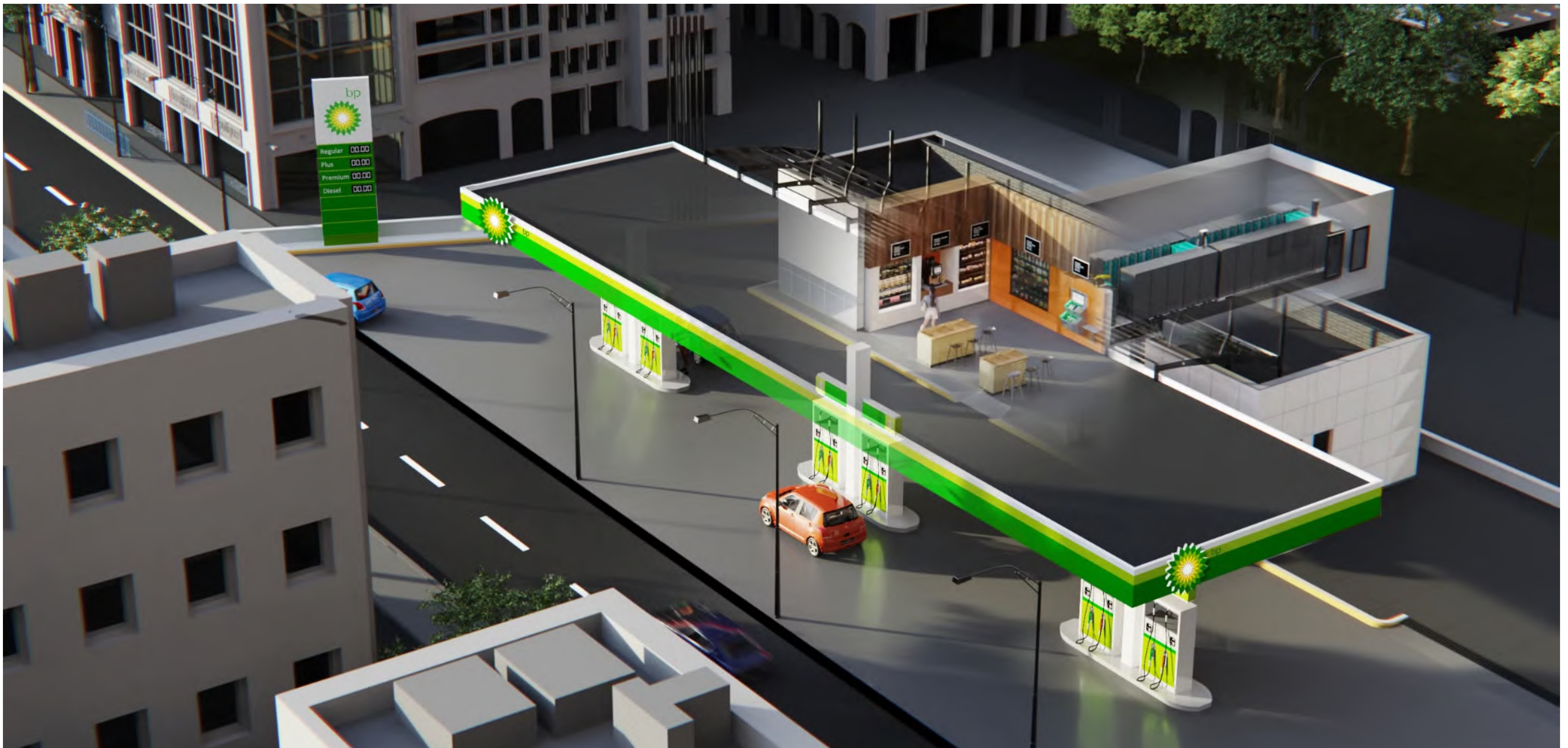

**AUTONOMOUS C-STORES**



**OR STAND-ALONE AUTONOMOUS STORES**



# A solution which boosts retail profitability

provided in a monthly rental model and set up in days.

## We expand top line revenue:

- 24/7
- Omnichannel
- Upselling
- Personalization

## While improving bottom line profit:

- Theft
- Labor cost
- Real estate footprint
- Stock management

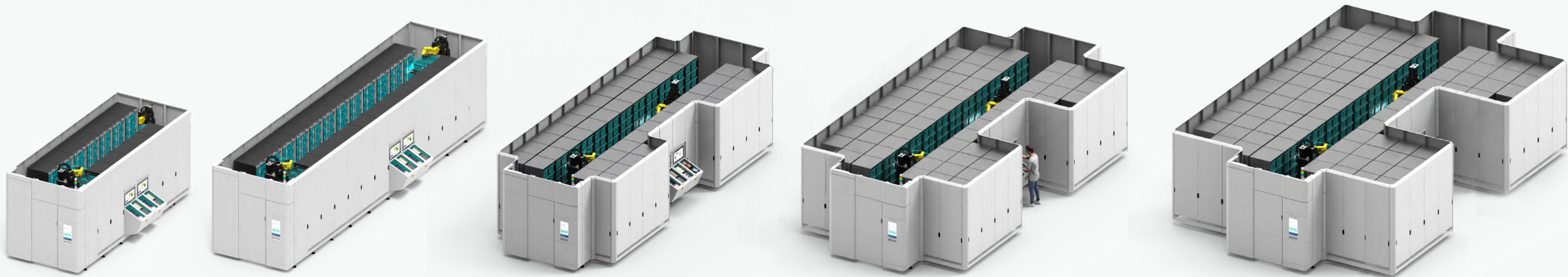

20ft module  
 ~16 sqm / ~172 sq. ft.  
**(144 totes / ~500 SKUs)**

40ft module  
 ~32 sqm / ~345 sq. ft.  
**(252 totes / ~900 SKUs)**

Expanded 40ft module  
 ~48 sqm / ~515 sq. ft.  
**(480 totes / ~1,500 SKUs)**

Expanded 40ft module  
 ~66 sqm / ~702 sq. ft.  
**(696 totes / ~1,750 SKUs)**

Fully expanded 40ft module  
 ~84 sqm / ~858 sq. ft.  
**(900 totes / ~2,000 SKUs)**

A **modular size** that fits into any existing space.



From **\$9,000** / month  
For the smallest size

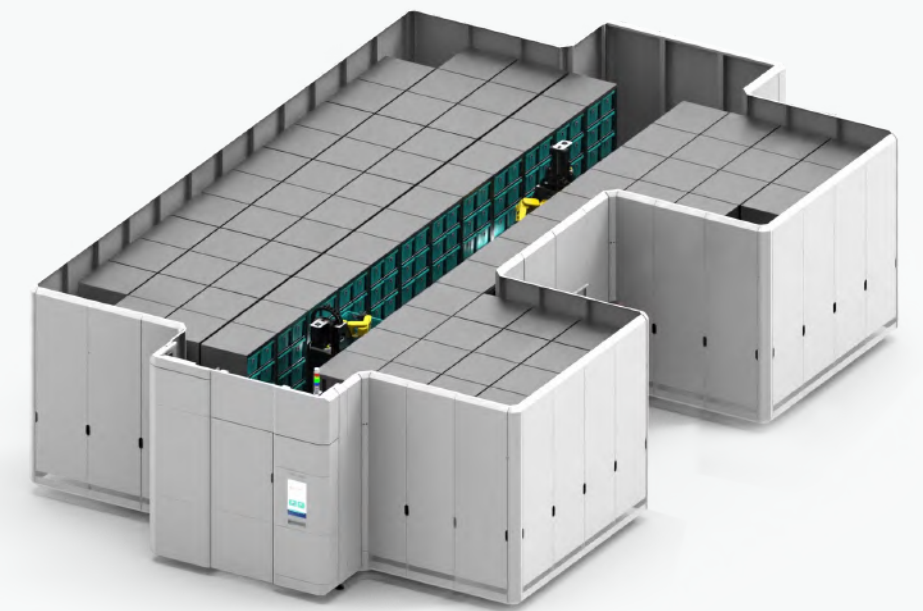

Up to **\$15,000** / month  
For the fully expanded model

A **modular pricing** dependent on system size and extensions.



**But wait, what about camera-vision based stores?**

... like Trigo, AiFi or Amazon Go? Why isn't that already in my local supermarket?

# The blind spots of vision-based retail

## Theft

Customers are directly exposed to the stock

## Upfront costs

Setting up camera coverage around a store is challenging

## Operational Costs

Shelving is limited for camera coverage, worse real estate density than traditional stores

## Reliability

Never 100%, requires employee intervention

# Replenishment

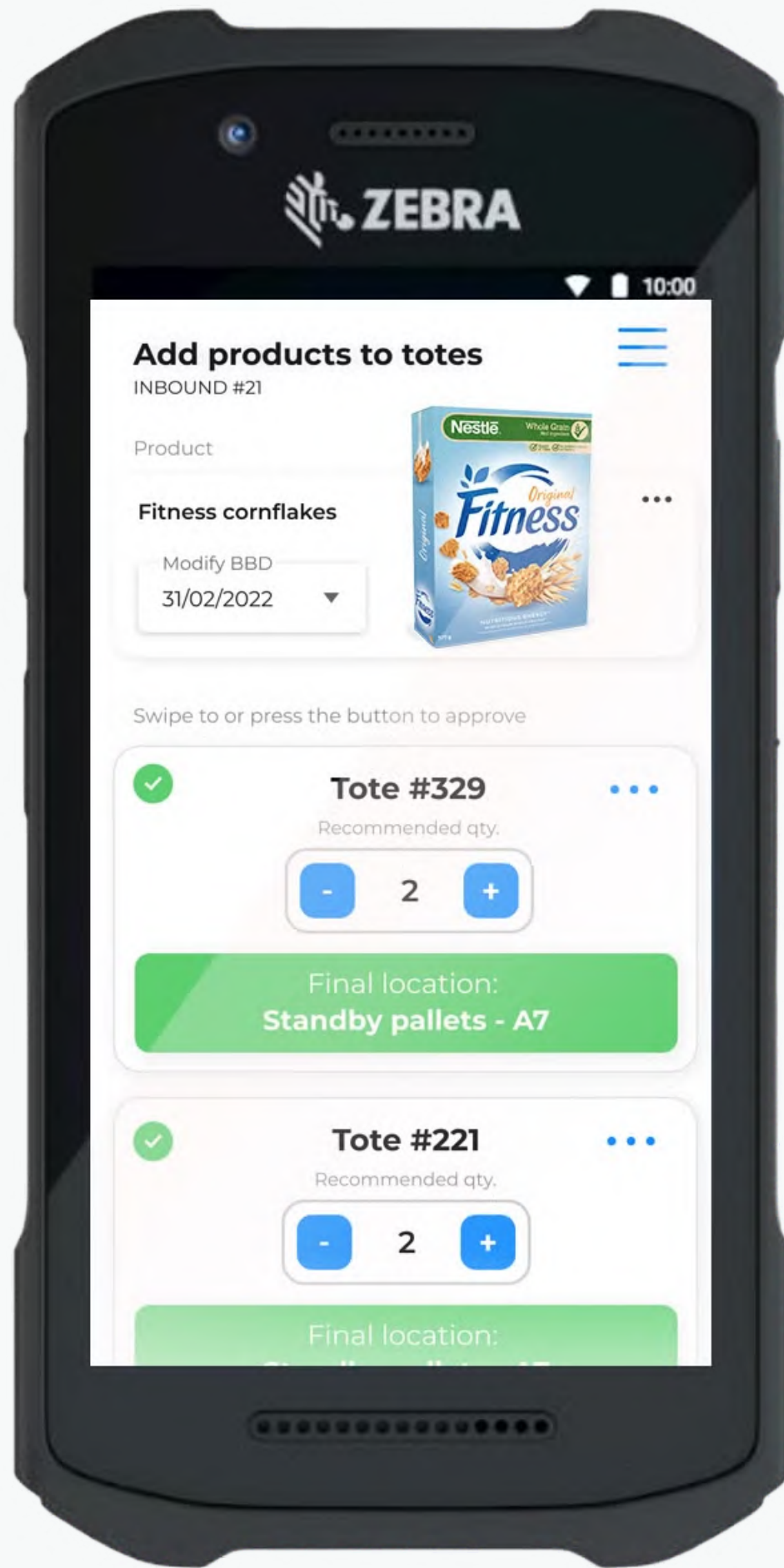

# Replenishment App

Guides the replenisher on the placement of each item and seamlessly links the goods to the totes.

Once filled, the totes are placed in the racks for rack replenishment or are inserted into the system for single tote replenishment.

# AI-guided staging station

## Inbound process

Use the staging station to prepare totes for system restocking - either on a rack (12 tote set) or as single individual totes.







Full rack replenishment

Single tote replenishment

Single item replenishment

## Quick, easy and safe replenishment

Can be done by anyone with minimal training.  
Loaded in minutes, zero interruptions!

Full rack replenishment

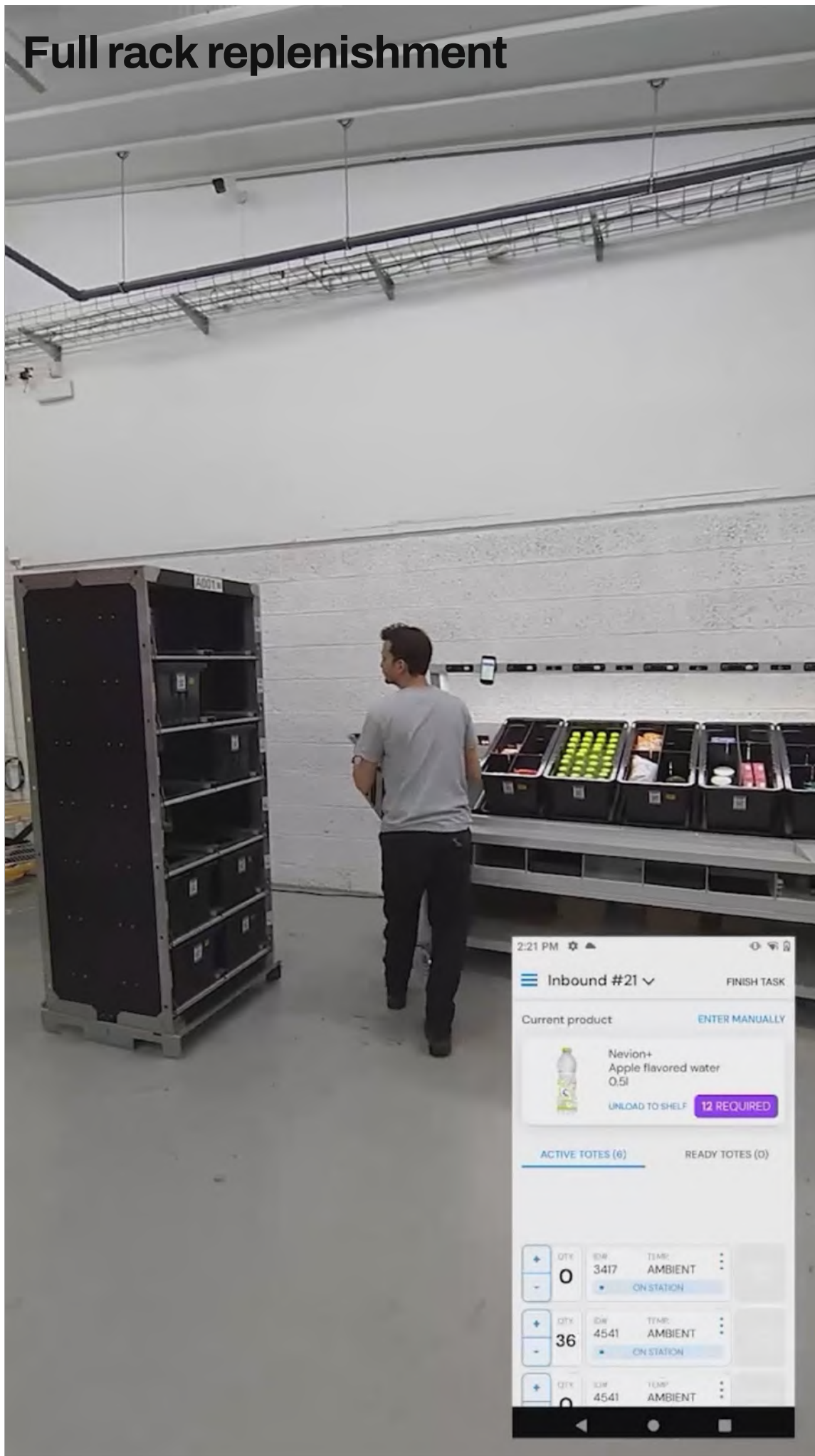

Single tote replenishment



# Quick, easy, and safe replenishment

Can be done by anyone with minimal training.  
Loaded in minutes, zero interruptions!



**Presented at the NRF 2024 conference in NYC together with Microsoft**

**Thank you**

**IIIIROBOTICS**