

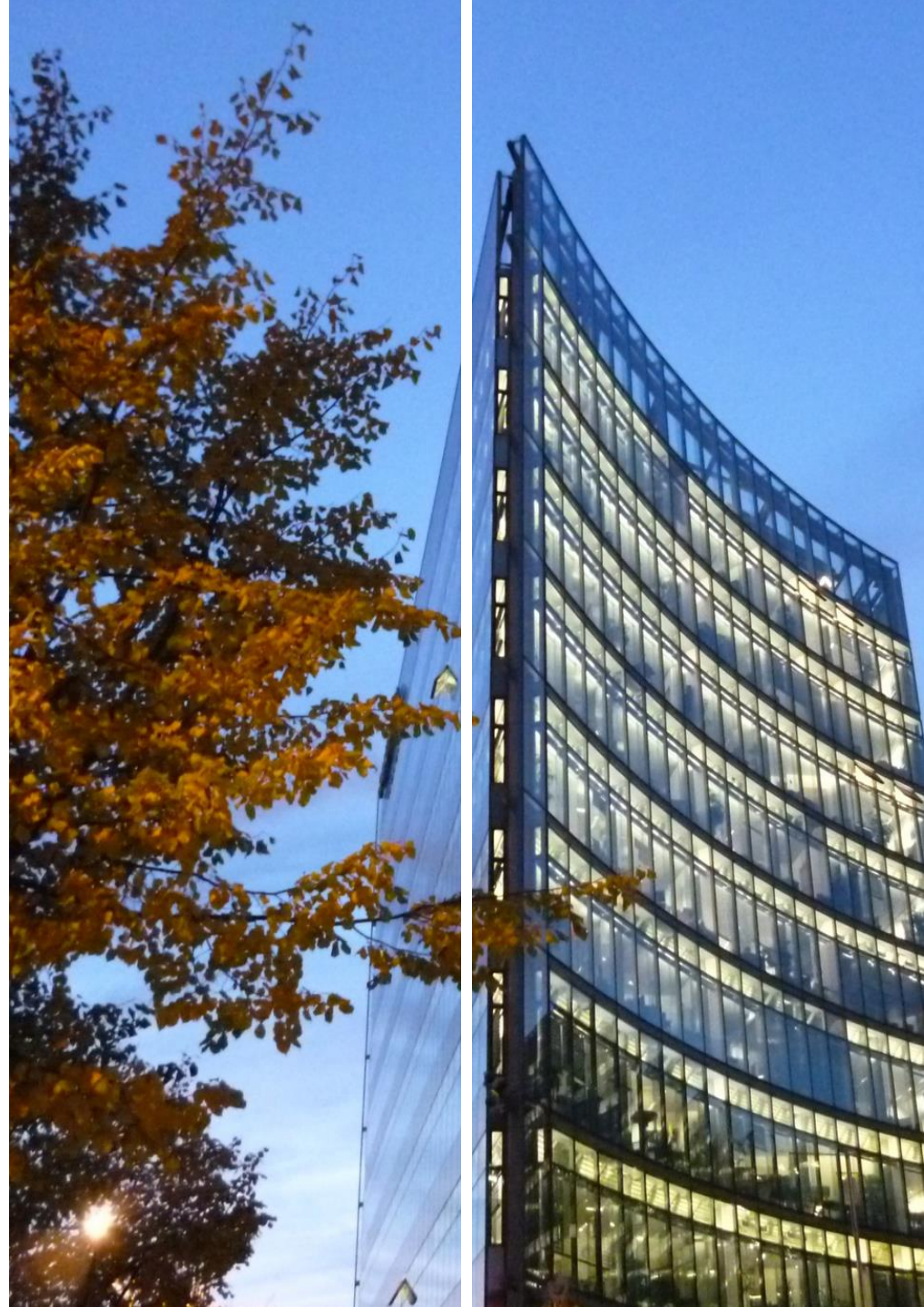

everpaths
by **itsoft**



Indoor and
outdoor
location and
wayfinding



What is Everpaths?

It is an end-to-end solution that leverages **spatial information and location technologies** to create more personalized, efficient and interactive experiences, while providing opportunities to optimize resource management and make informed decisions.

Everpaths is a wayfinding solution which **has the ability to locate assets and people** and guide a user via a device, for example a smartphone, inside or outside a building in real time, as well as collecting statistical usage information from users in a central database.



Who is it for?

Everpaths is a solution designed for companies or organizations that manage exceptional buildings with significant flows of people, such as office buildings, shopping centers, hotel & resorts, airports and station and more.

Moreover, this personal and digital guide provides the building manager with a new communication channel through which offer direct information to people who are or have been sometime in the building.



Everpaths allows you



Location

The map shows the users or assets position and also provides information about the most relevant point of interest near the user.



Wayfinding

The user selects a destination in space and gets a map with detailed instructions based on their location, to easily reach the destination.



Geopositioned content

The contents are associated with the exact location where they are in space, so that they can be consulted in an orderly and intuitive way.



Audio guide

The application allows the user to listen to the automatic reading of the contents, making Everpaths a powerful, cost-effective and easy-to-maintain audio guide solution.



Communication channel

You can send push notifications to users who are or have been in a certain room or area of the managed space.



Customization

The application can be customized with the corporate image of the building and adapted to the needs of the building.



Statistics

The exploitation of Big Data generated from anonymous visit data, such as common atform enables the routes, information requests, and occupancy data.



Suggested routes

It can recommend routes to users for a better use of the visit.

Advantages for your building

- Enables effective real-time monitoring of personnel and assets, improving safety and operational efficiency.
- Provides valuable data through gauging heat maps that allow managers to analyze movement patterns through interactive maps and real-time statistics.
- Enables compatibility and interoperability with other systems such as BMS, BPS or other intelligent building management systems.
- Facilitates location and navigation inside and outside buildings, reducing wasted time and improving the overall user experience.
- Ensures security, reliability and scalability of the service, backed by Microsoft Azure's robust infrastructure.

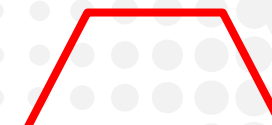
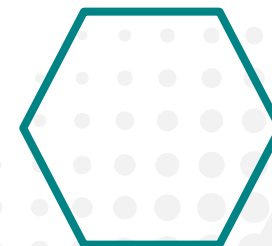

How does it work?

Management Web platform

Anonymously collects usage data that will allow a detailed analysis of the flow of people in the buildings, as well as preferences of origins and destinations and the times at which they travel.

Mobile app IOS y Android

The app for mobile devices is responsible for obtaining the necessary information from the environment to locate the user, display maps with the user's position and show nearby contents..

Positioning technology

The location of assets and people is achieved thanks to position beacons and/or tags that are detected by the **Everpaths** system.

Also through the obtaining of the position according to the visible wifi access points or the device's own GPS.

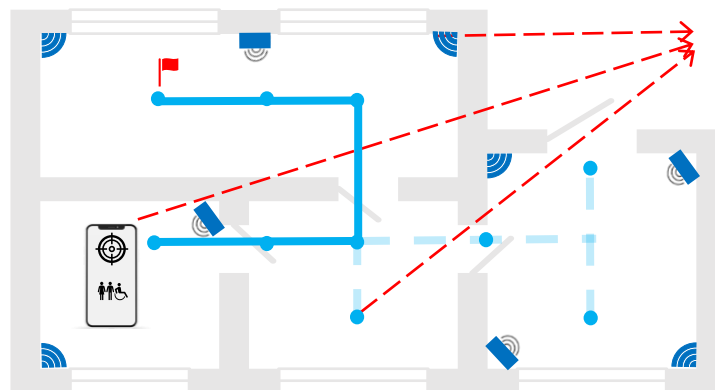

Optimise your buildings, Innovation for Smart buildings



Multisector solution

- Buildings
- Hospitals and healthcare centers
- Shopping centers
- Museums and exhibitions
- Airports and trains stations
- Public buildings
- Trade fairs and congresses
- Universities



Buildings

With **Everpaths**, buildings are transformed into smart environments that prioritize comfort, security and efficiency, offering a new dimension of ease and well-being to those who visit them.

It opens up a range of possibilities by enabling the provision of new services such as the location of meeting rooms and/or offices, reservations, occupancy tracking, asset location and additional advantages such as integration with Building Management Systems (**BMS**), Property Management System (**PMS**), and more.

All this is possible thanks to the availability of spatial information, interaction with the environment and location-based communications with visitors.

Improving efficiency, safety
and operational
coordination

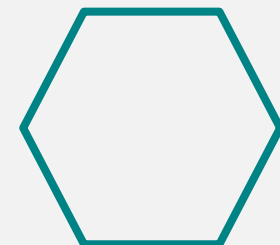
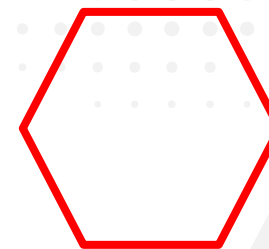

Museums and exhibitions

Everpaths enables museum and exhibition managers to effectively manage digital content (images, videos, audios, augmented reality, etc.) for permanent and temporary exhibitions. They can schedule changes through the solution's web interface.

With **Everpaths**, they can offer audio guides directly from the visitor's smartphone through a customized application adapted to the museum's image.

In addition, they can collect information about their visitors, including habits, visit frequencies, durations, profiles and areas of interest.



Improve visitor
experience, learn from
visitors

Hospitales y centros sanitarios

With **Everpaths**, healthcare facility managers can easily locate assets and people, providing patients, visitors and medical staff with precise directions to a specific location within the hospital.

This facilitates navigation and reduces time spent searching for directions.

It also allows them to learn from movement patterns in the hospital to redesign flows and spaces, making them more accessible

Control your assets and improve patient experience



Shopping centers

Our innovative indoor positioning technology will completely transform the visitor experience in shopping malls.

With **Everpaths**, visitors will be able to effortlessly navigate the mall, discover offers and stores, and enjoy personalized attention, all from the convenience of their smartphones.

Mall managers using **Everpaths** will gain accurate data to optimize asset management, improve traffic flows and make informed strategic decisions.



Airports and stations

With **Everpaths**, bus, train and airport stations can optimize operational management, enhance security and deliver an exceptional travel experience for passengers.

It enables seamless indoor and outdoor navigation and orientation for travelers, providing accurate, real-time directions to boarding gates, services and points of interest.

Managers can use the data collected by **Everpaths** to analyze trends, passenger flow patterns and improve strategic planning.

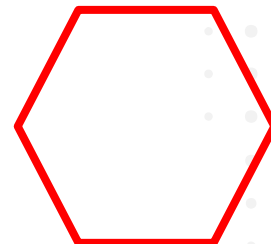

About **ITSOFT**

In **ITSOFT**, we have been at the forefront of custom technology development, especially in mobility environments, for more than two decades and we offer a broad portfolio of our proprietary off-the-shelf solutions.

Our products and services include software solutions (SaaS), cloud services and consulting.

Our solutions have been widely adopted by businesses of all sizes and sectors, supporting digital transformation.

We are recognized for our commitment to quality and information security. We are certified in **Quality Management Systems under ISO 9001** and **Information Security Management Systems under ISO 27001**.



References

Acciona	ADIF	Administración General del Estado (CORA)	Aena	Agencia EFE	Airbus Defence & Space	Amazon	AtlanticaYield	AVON
Ayesa	Ayuntamiento de Madrid	Banco Mediolanum	BASF	BBVA	Bidafarma	Binter	BP	British American Tobacco
C.T.C. Servicios Ambientales	Caja Rural	Cáritas	Catalana Occidente	Catec	Central lechera Asturiana	Cl@ve – Gobierno de España	Covap	Covermanager
Cruz Roja	Diputación de Barcelona	Diputación de Sevilla	Diputación de Tarragona	Emasesa	Endesa	Enecé	Erum	Eurosemillas



References



GAT
Fertilizantes



Generalitat de Catalunya



Grúas Lozano



Grupo Attendis



Guardia Civil



Heineken



Iberdrola



Iberfruta



ISS Ibérica



Junta de Andalucía



Junta de Castilla y León



Lácteas García Vaquero



Mango



Manpower



Merck España



Ministerio de Defensa



Museos Dalí



Myopen



ONCE



Principado de Asturias



RCD Espanyol



Red.es



Redsys



Refrival



Roche Farma



Sacyr



Orden hospitalaria San Juan de Dios



SEAT



Soloptical



Supermercados MAS



Surexport



Unidental



Universidad Autónoma de Madrid



UVESCO



Vodafone



Xunta de Galicia

Contact with us

itsoft

With our technological solutions we can help you increase your company's productivity, reduce costs and generate new services.

 (+34) 955087700

 info@itsoft.es

 <https://www.itsoft.es/>

 Seville - Madrid – Barcelona - Lisbon

Learn more about our solutions



itsoft





www.everpaths.com