

Prevent Construction Delay with

SmartProject

With SmartProject, project management is faster, cheaper and a thousand times more efficient than traditional methods. Here's a quick look at how it works.

***"Identifying the problem
is half the solution."***



Problem

- **Inefficient/Unrealistic Planning**

Cause: Not done with the end in mind

- **Unable to track and monitor progress**

Cause: Progress updates captured manually

- **Stakeholders don't follow the process**

Cause: Human error, human managers who struggle to enforce the process

Solution

- **AWP based planning.**

How: Plan and monitor IWP Packages

- **Earned value based monitoring**

How: Automatically capture progress

- **System-driven (QMS)**

How: Enforce Quality Process & procedures automatically

**SmartProject is the perfect
solution for EPC projects
because...**



SmartProject enforces your business process

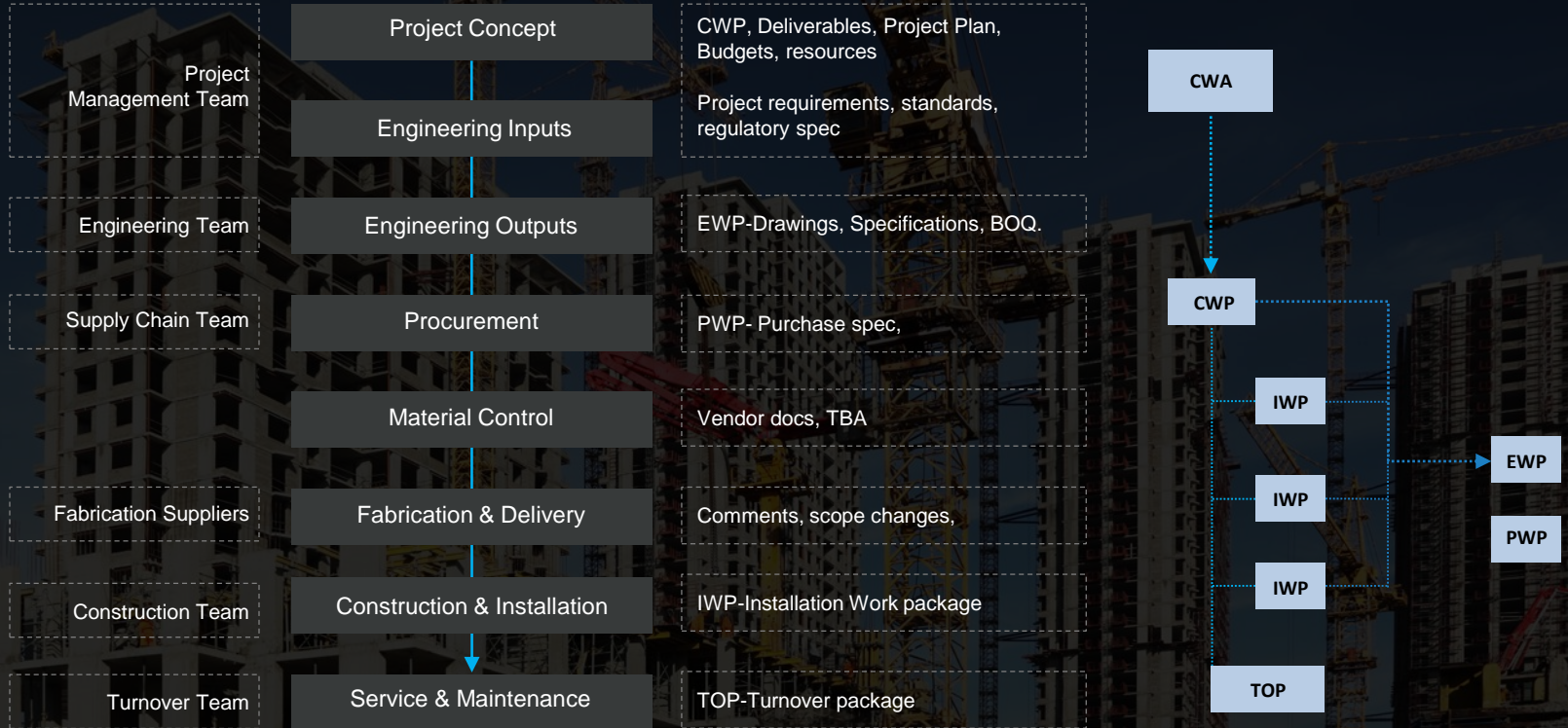

...through EVM-based monitoring

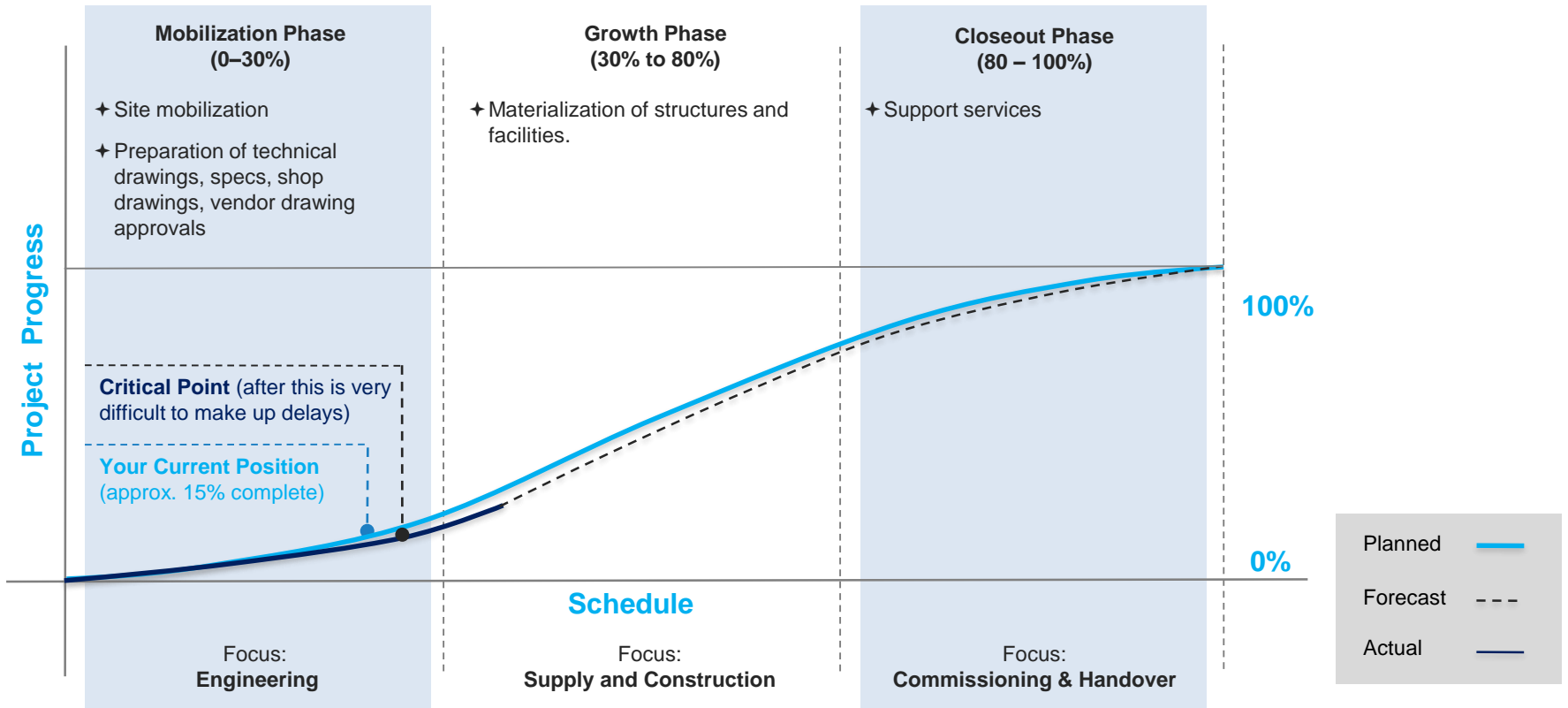

...and an automated QMS

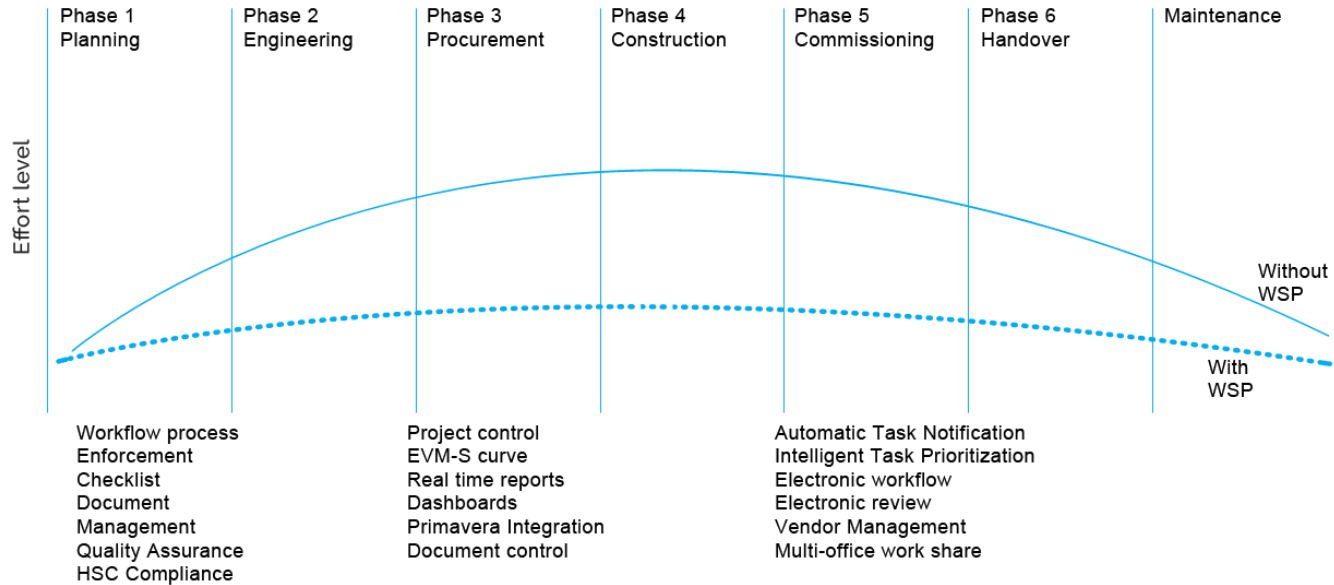

...that ties everything together.



The core is engineering.

”

Engineering deliverables need to be ahead of schedule by at least five percent because if engineering is done on time it is likely that everything else will happen on time.

Daniel Wong

Project Director at China Petroleum Engineering & Construction Corporation (CPECC)

Complete design on time, and the rest will follow.

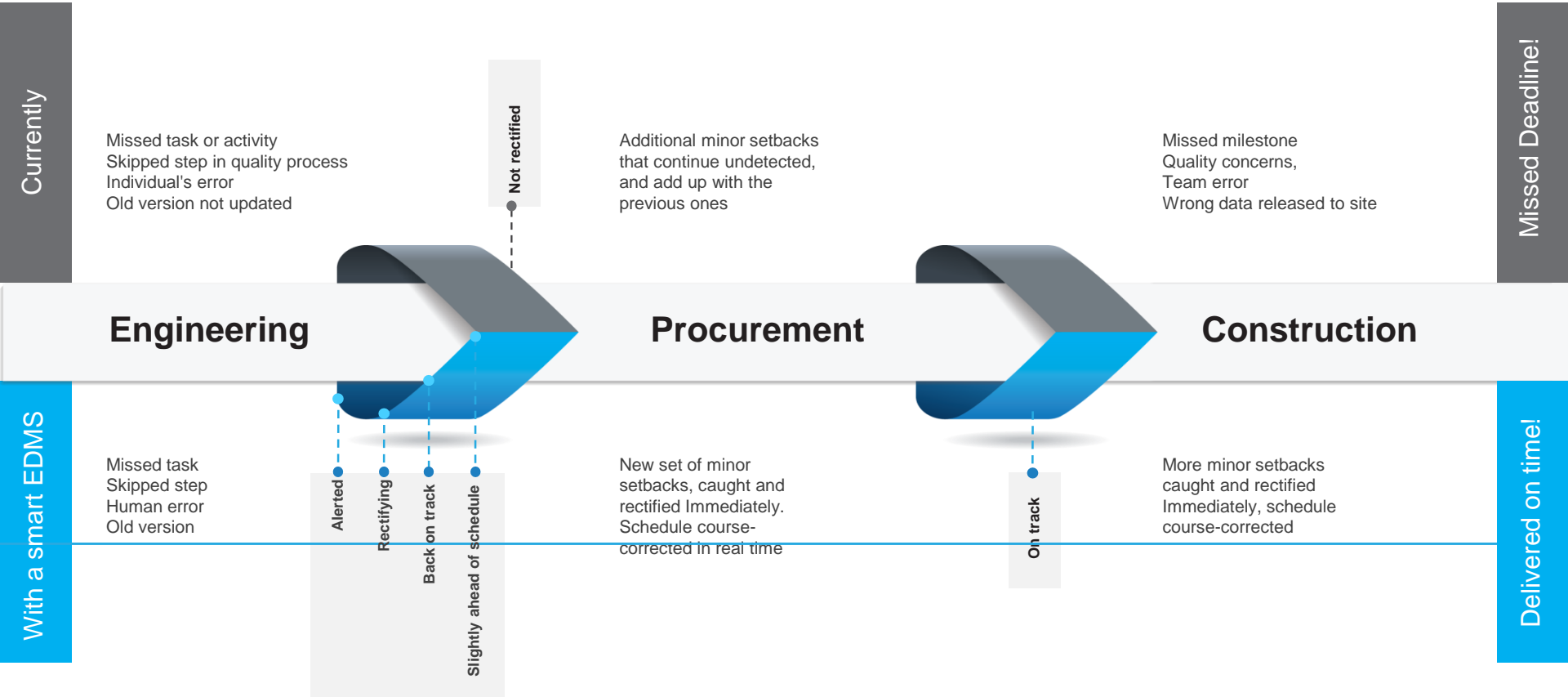

**A smartly-managed project
starts with great Planning.**



Planning: Manpower and Resource Management

E

- ✦ Productivity up by 20-25%
- ✦ Direct access to Multiple EPC Contractors/vendors
- ✦ Assurance of working only with latest revisions

P

- ✦ Automated inspection process
- ✦ 100% standardization and accuracy/quality in inspection
- ✦ Transparency and accountability (internal & external)
- ✦ Documentation for non-EPC activities standardized automated

C

- ✦ System-driven To-Do lists for all resources (updated by system)
- ✦ Online, real-time site work tracking
- ✦ 'Live' project progress dashboard
- ✦ 100% multi-level security

Planning: Procurement

➔Procurement Services: MR, TBE, Vendor Documents

➔Level 4: Equipment list

Sr. No.	Item Description	MR No	Activity ID (Baseline Plan)	Wt. %	
				Level 4 (As per WBS)	Level 5 (As per WBS)
	PIPING (BULK)				
1	Gaskets	BM-5267-5000-PI-003 Rev 0	HPBLPI0070 / HPBLPI0080 / HPBLPI0090 / HPBLPI0100 / HPBLPI0110 / HPBLPI0120	2.00%	6.26%
2	Stud Bolts	BM-5267-5000-PI-003 Rev 0	HPBLPI0070 / HPBLPI0080 / HPBLPI0090 / HPBLPI0100 / HPBLPI0110 / HPBLPI0120	2.00%	6.26%
3	Fittings	Jacketted Pipe and Fitting 5267-5000-PI-002 Rev B1 Non-Metallic Piping, Flanges and Fittings 5267-5000-PI-007 Rev R1 SS Piping, Flanges and Fittings 5267-5000-PI-005 Rev B1	HPBLPI0010 / HPBLPI0020 / HPBLPI0030 / HPBLPI0040 / HPBLPI0050 / HPBLPI0060	2.50%	7.83%

➔Level 5: Rule of Credit for Procurement Services

Prepare MR / PR	Float Enquiry	Receive Offers	Complete Vendor Clarifications	Complete Eval. & Submit TBE to COMPANY	Receive COMPANY Approval	Commit / Issue P.O.	Receive & Approve Vend. Drgs (Major)	Compl. Mfg.	Compl. Final Inspection	Compl. Mat'l Dispatch	Receive Mat'l at Site (Complete)	Prepare MRV
P/N/F/A	P/N/F/A	P/N/F/A	P/N/F/A	P/N/F/A	P/N/F/A	P/N/F/A	P/N/F/A	P/N/F/A	P/N/F/A	P/N/F/A	P/N/F/A	P/N/F/A
5%	8%	10%	15%	20%	25%	35%	45%	70%	80%	90%	98%	100%

**Smart Collaboration makes
everybody Work As One.**



**Smart Monitoring helps
anticipate and prevent
delay.**



Monitoring: Integrated Project Management

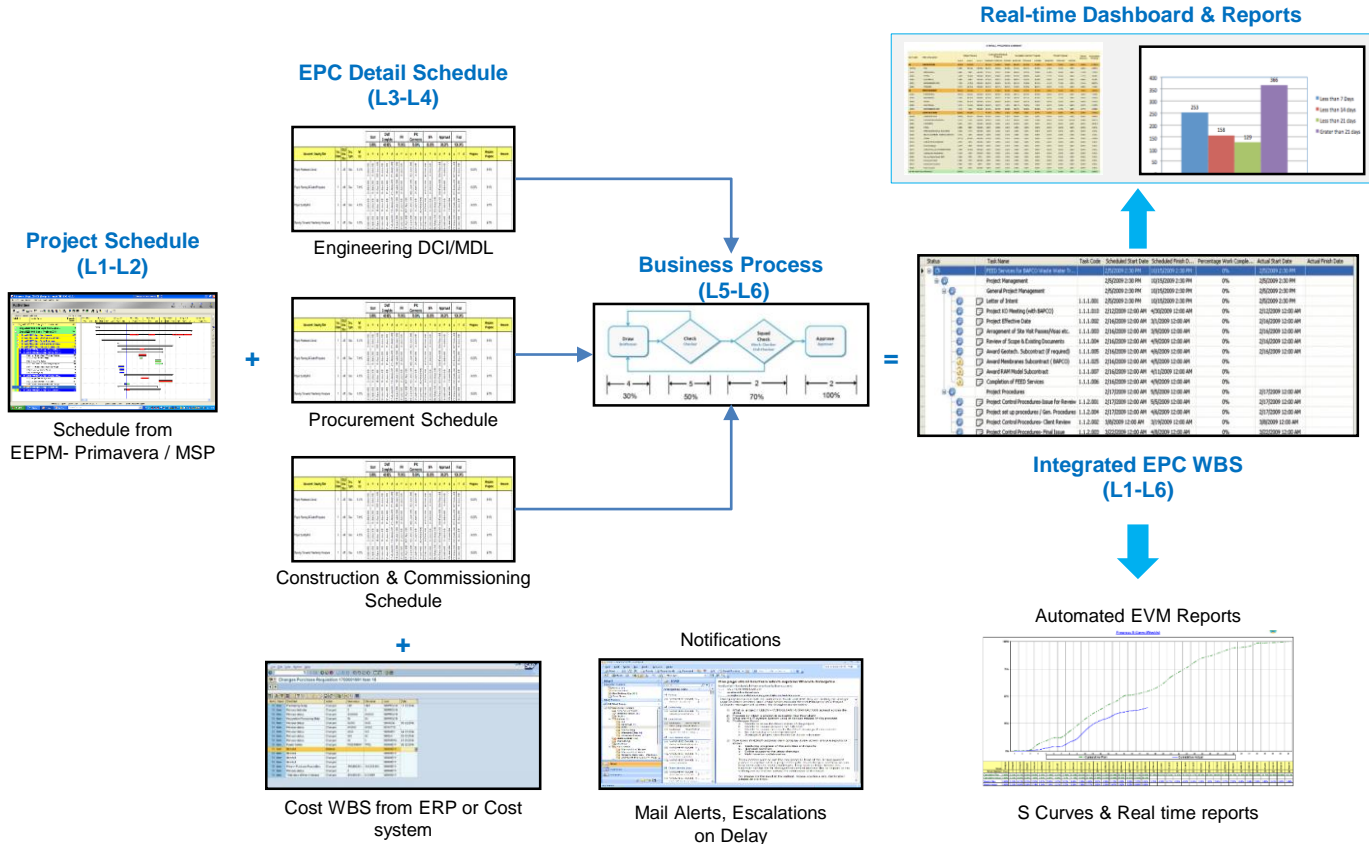

Monitoring: Dashboards and reports

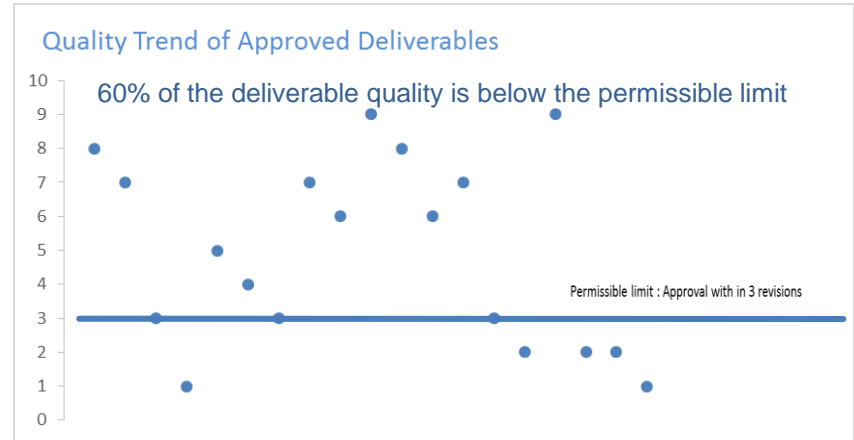
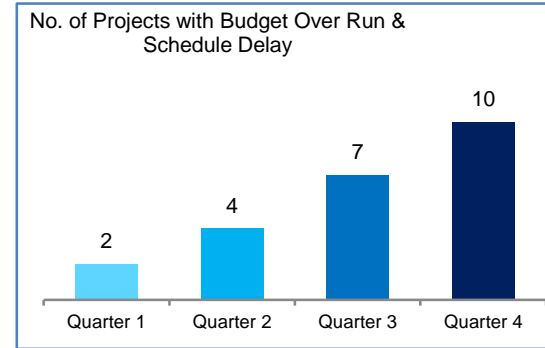
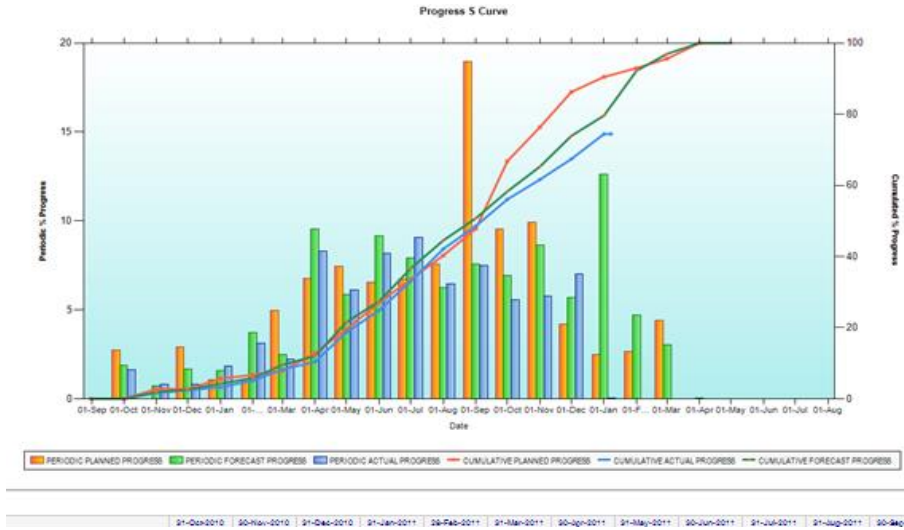

**Last but not least, a smart
solution works happily with
other software.**



Integration with 3D CAD

Planning in Primavera

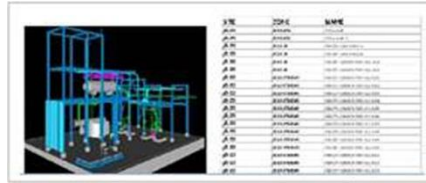

3D Model Hierarchy from PDMS

WRENCH WBS is created with Primavera schedule, PDMS hierarchy and PDMS status are defined and linked

Actuals are pushed to Primavera

Progress is captured in WRENCH WBS

ID	DATE	ME	WF	TOTDAYS	TR	STATUS	STATUS
01	2010/01/01	0	0	0	0	0	0
02	2010/01/01	0	0	0	0	0	0
03	2010/01/01	0	0	0	0	0	0
04	2010/01/01	0	0	0	0	0	0
05	2010/01/01	0	0	0	0	0	0
06	2010/01/01	0	0	0	0	0	0
07	2010/01/01	0	0	0	0	0	0
08	2010/01/01	0	0	0	0	0	0
09	2010/01/01	0	0	0	0	0	0
10	2010/01/01	0	0	0	0	0	0
11	2010/01/01	0	0	0	0	0	0
12	2010/01/01	0	0	0	0	0	0
13	2010/01/01	0	0	0	0	0	0
14	2010/01/01	0	0	0	0	0	0
15	2010/01/01	0	0	0	0	0	0
16	2010/01/01	0	0	0	0	0	0
17	2010/01/01	0	0	0	0	0	0
18	2010/01/01	0	0	0	0	0	0
19	2010/01/01	0	0	0	0	0	0
20	2010/01/01	0	0	0	0	0	0
21	2010/01/01	0	0	0	0	0	0
22	2010/01/01	0	0	0	0	0	0
23	2010/01/01	0	0	0	0	0	0
24	2010/01/01	0	0	0	0	0	0
25	2010/01/01	0	0	0	0	0	0
26	2010/01/01	0	0	0	0	0	0
27	2010/01/01	0	0	0	0	0	0
28	2010/01/01	0	0	0	0	0	0
29	2010/01/01	0	0	0	0	0	0
30	2010/01/01	0	0	0	0	0	0
31	2010/01/01	0	0	0	0	0	0
32	2010/01/01	0	0	0	0	0	0
33	2010/01/01	0	0	0	0	0	0
34	2010/01/01	0	0	0	0	0	0
35	2010/01/01	0	0	0	0	0	0
36	2010/01/01	0	0	0	0	0	0
37	2010/01/01	0	0	0	0	0	0
38	2010/01/01	0	0	0	0	0	0
39	2010/01/01	0	0	0	0	0	0
40	2010/01/01	0	0	0	0	0	0
41	2010/01/01	0	0	0	0	0	0
42	2010/01/01	0	0	0	0	0	0
43	2010/01/01	0	0	0	0	0	0
44	2010/01/01	0	0	0	0	0	0
45	2010/01/01	0	0	0	0	0	0
46	2010/01/01	0	0	0	0	0	0
47	2010/01/01	0	0	0	0	0	0
48	2010/01/01	0	0	0	0	0	0
49	2010/01/01	0	0	0	0	0	0
50	2010/01/01	0	0	0	0	0	0
51	2010/01/01	0	0	0	0	0	0
52	2010/01/01	0	0	0	0	0	0
53	2010/01/01	0	0	0	0	0	0
54	2010/01/01	0	0	0	0	0	0
55	2010/01/01	0	0	0	0	0	0
56	2010/01/01	0	0	0	0	0	0
57	2010/01/01	0	0	0	0	0	0
58	2010/01/01	0	0	0	0	0	0
59	2010/01/01	0	0	0	0	0	0
60	2010/01/01	0	0	0	0	0	0
61	2010/01/01	0	0	0	0	0	0
62	2010/01/01	0	0	0	0	0	0
63	2010/01/01	0	0	0	0	0	0
64	2010/01/01	0	0	0	0	0	0
65	2010/01/01	0	0	0	0	0	0
66	2010/01/01	0	0	0	0	0	0
67	2010/01/01	0	0	0	0	0	0
68	2010/01/01	0	0	0	0	0	0
69	2010/01/01	0	0	0	0	0	0
70	2010/01/01	0	0	0	0	0	0
71	2010/01/01	0	0	0	0	0	0
72	2010/01/01	0	0	0	0	0	0
73	2010/01/01	0	0	0	0	0	0
74	2010/01/01	0	0	0	0	0	0
75	2010/01/01	0	0	0	0	0	0
76	2010/01/01	0	0	0	0	0	0
77	2010/01/01	0	0	0	0	0	0
78	2010/01/01	0	0	0	0	0	0
79	2010/01/01	0	0	0	0	0	0
80	2010/01/01	0	0	0	0	0	0
81	2010/01/01	0	0	0	0	0	0
82	2010/01/01	0	0	0	0	0	0
83	2010/01/01	0	0	0	0	0	0
84	2010/01/01	0	0	0	0	0	0
85	2010/01/01	0	0	0	0	0	0
86	2010/01/01	0	0	0	0	0	0
87	2010/01/01	0	0	0	0	0	0
88	2010/01/01	0	0	0	0	0	0
89	2010/01/01	0	0	0	0	0	0
90	2010/01/01	0	0	0	0	0	0
91	2010/01/01	0	0	0	0	0	0
92	2010/01/01	0	0	0	0	0	0
93	2010/01/01	0	0	0	0	0	0
94	2010/01/01	0	0	0	0	0	0
95	2010/01/01	0	0	0	0	0	0
96	2010/01/01	0	0	0	0	0	0
97	2010/01/01	0	0	0	0	0	0
98	2010/01/01	0	0	0	0	0	0
99	2010/01/01	0	0	0	0	0	0
100	2010/01/01	0	0	0	0	0	0

PDMS status are exported

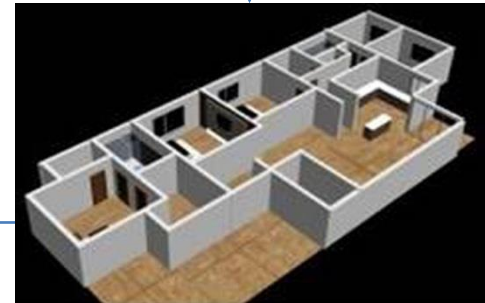

Modeling is done and PDMS status are updated

Integration with ERP and Primavera

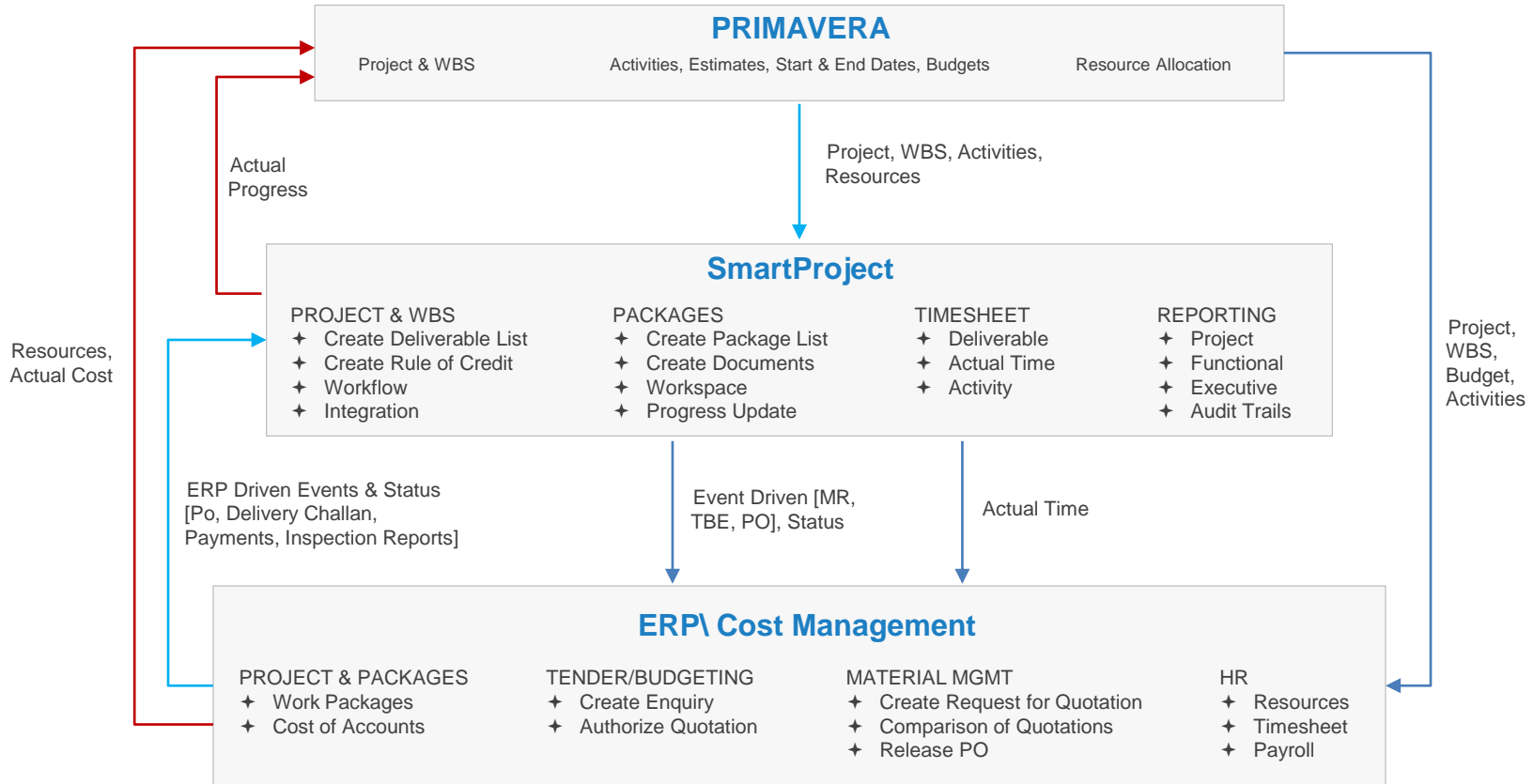

Meet the people behind SmartProject.





Neal Cornwell
President

"Smart means doing a lot more with a lot less."



Varghese Daniel
Chief Executive Officer

"Reducing risk and increasing profit margins is smart."



Aju Peters
Chief Technology Officer

"Smart technology adapts to the user, not the other way around."



Manesh Alias
Chief Operations Officer

"Intelligent IT builds a loyal user base."

Our technology is used on over

8000 projects
worldwide

- ✦ The EPC industry is governed by processes. We've been serving the industry for 20 years and have created a custom-made solution for our clients in addition to software.
- ✦ Our solution caters to different industry verticals that helps run critical projects on time and within budget.



Our clients include



Global Network

North America

WRENCH Solutions LLC (Houston)
WRENCH Solutions Americas Inc. (Ontario)
WRENCH Solutions Americas Inc. (Calgary)

Europe

WRENCH Solutions Ltd. (London)

Middle East

WRENCH Solutions (P) Ltd. (Abu Dhabi, UAE)

APAC

WRENCH Solutions PTY Ltd. (Australia)
WRENCH Solutions (PTE) Ltd. (Singapore)
WRENCH Solutions (PTE) Ltd. (Malaysia)
WRENCH Solutions (P) Ltd. (India)

Corporate Data

WRENCH Solutions Private Limited
R&D Centre: Kochi SEZ, Kerala, India.