



# Flex Flow

AUTOMATE YOUR BIM DATA CHECKS





# Intro to xbim

---

## Founded by experts in BIM

xbim is a UK based company spun out of the open source Xbim Toolkit development team.

Flex is our commercial product, a developer-centric platform offering comprehensive data hosting and a suite of technical modules for the rapid development of BIM and Digital Twin technologies that are cloud-native.

# Introducing Flex Flow

Flex Flow is our automation application on the Flex platform. Flex Flow allows you to create workflows that can automatically check and verify data within your IFC model.

Flow can be used to verify data as part of ISO19650, perform high level embodied carbon checks and clash detection.

You can use Flex Flow as an API for integration with your own product and process or you can use our standalone, no-install product.

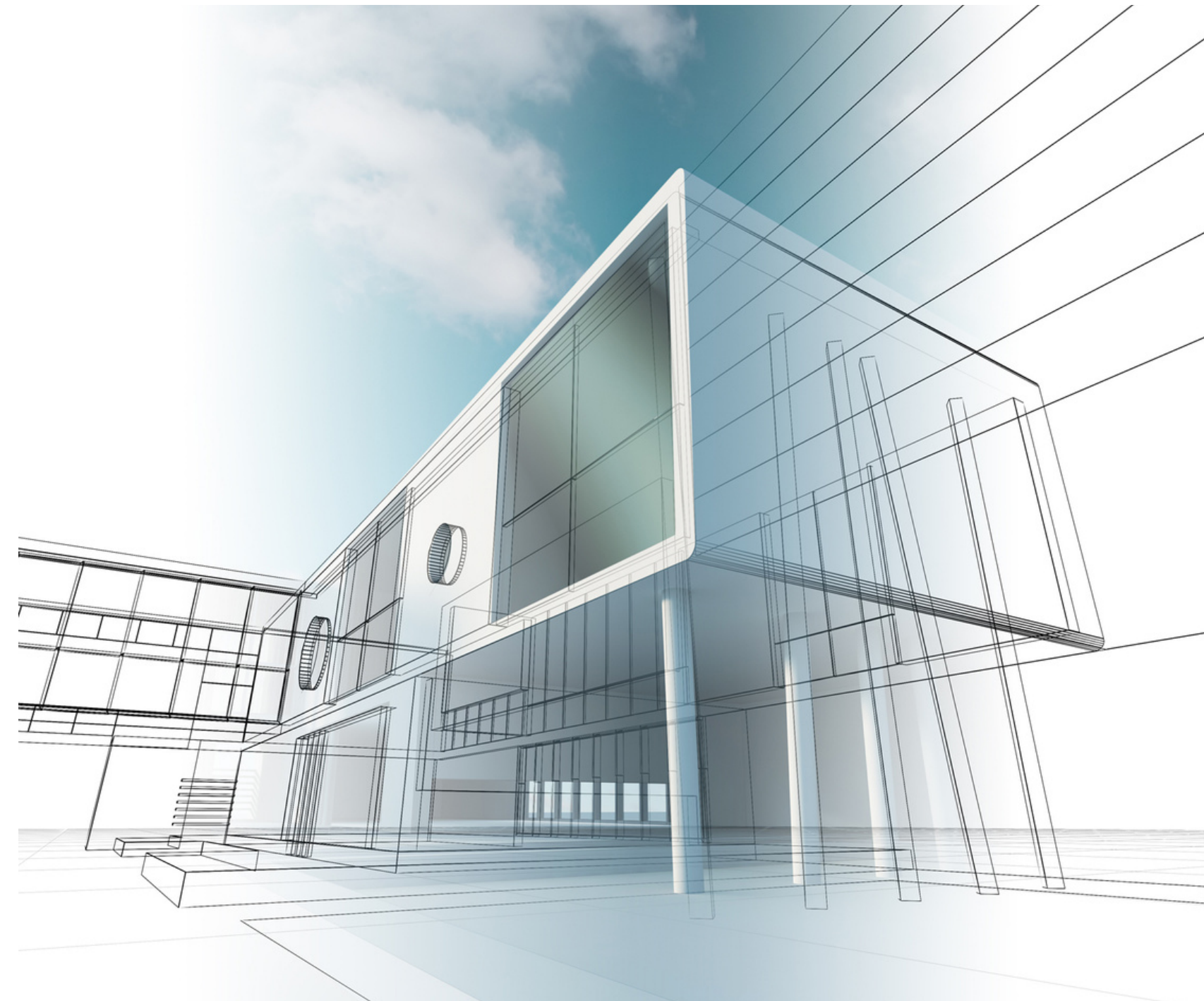

---

## **Training and Tutorials**

We offer a range of training guides and materials to support understanding of IFC and OpenBIM. Our developer portal also provides guides and tutorials to help you use the Flex Flow API.

---

## **Consultancy**

If you're using the API we offer consultancy time with our team of developers to help you integrate Flow quickly and effectively.



# 02 Getting Started with Flex Flow

# Thank You

**Ready to get started with Flex?**

Contact us:

[andy.ward@xbim.net](mailto:andy.ward@xbim.net)

[adrienne.baird@xbim.net](mailto:adrienne.baird@xbim.net)