

Reference Customers

2020-03-12

Visit: www.mapiq.com

Partner ID: 6172192



Deloitte's the Edge, Amsterdam

This is where it all began. Mapiq supports Deloitte's employees making effective use of the activity-based work environment in a ground-breaking office building in Amsterdam's business district the Zuid-as.

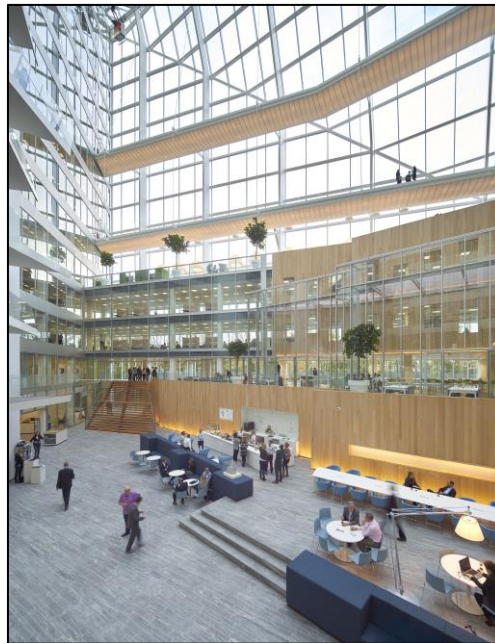

- Data analytics based on a the Aruba ALE Wi-Fi network, Pointgrab, Mapiq desk and room sensors and booking data.
- Improved employee experience with
 - Workplace finder
 - Room booking
 - Personal control of lights and lockers

Result: increased occupancy from 1.700 FTE to 2.700 FTE, saving EUR 3.5 million a year on housing cost. Increased job applications with 400% and reduced absence with 40%.

Microsoft Schiphol & Zaventem

Both the Microsoft Schiphol (Amsterdam) and Zaventem (Brussels) office are located next the airport. Employees and guests from all over the world come together to collaborate on high tech projects. Microsoft wanted their office to have a world class user experience showcasing the latest innovations in smart building and workplace applications.

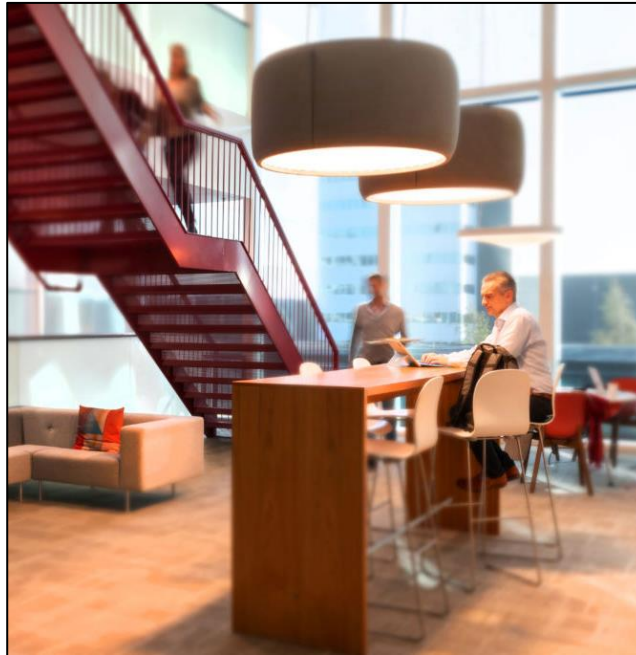

- Microsoft Netherlands and Belgium HQ
- Data analytics and location services.
- Improved employee experience with
 - Workplace finder
 - Colleague finder
 - Here & Now functionalities
 - Room control, lights, temperature, blinds

Thanks to Mapiq employees can easily make use of all the facilities. Finding your project team has become easy and it is even possible to talk to the building using Microsoft Cortana. Both offices are truly showcasing the future of work.

Unilever's Marketplace, New York

Global consumer goods company Unilever renovated its US Headquarters to become the most energy-efficient and intelligent office building on the East Coast. The building has numerous shared workspaces, inspirational areas and is both LEED and WELL certified.

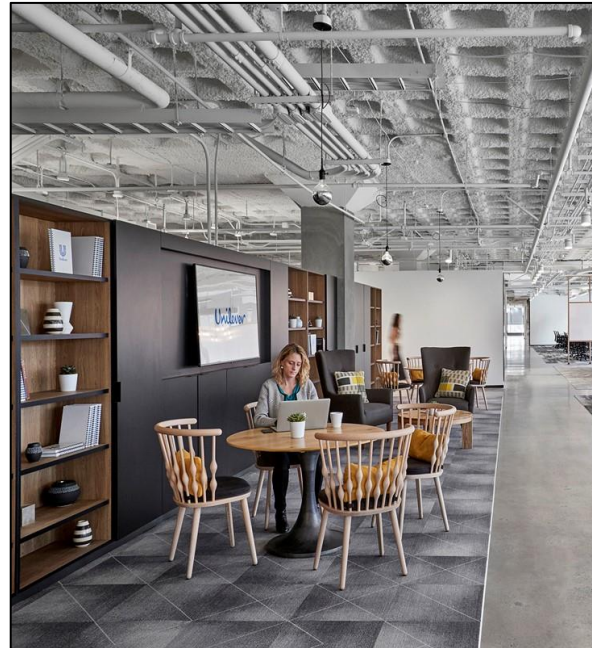

- Data analytics based on a the 4.850 sensors.
- Improved employee experience with
 - Workplace finder
 - Colleague finder
 - Room booking
 - Personal control of lights and temperature

Thanks to Mapiq the office building is now one of the best places to work in the New York city area. The implementation of our platform solution has resulted in decreased sense of workplace scarcity, tailoring workplaces on individual level, workspace optimization based on real-time data visualized in the Analytics dashboard

Virgin Media HQ, Reading UK

Virgin Media moved from the city center in London to one of the upcoming area's in Reading. This meant not only a change in location but also the introduction of activity-based working. Virgin Media decided to go all out with this new HQ and asked Mapiq to implement the full suite of functionality including the first ever integrated parking solution.



- Data analytics and localization based on 2.600 Mapiq sensors.
- Improved employee experience with
 - Workplace finder
 - Colleague finder
 - Room booking
 - Parking reservation
 - Locker control

Thanks to Mapiq employees don't need to worry about the limited parking space and are fully supported in their new way of working. Within the next 12 months Mapiq will also be implemented in the new Manchester office as well as the HQ of mother company Liberty Global in Schiphol.

KPMG all Zurich & Geneva offices

KPMG is one of the leading audit, tax and advisory firms. After running multiple pilots they decided to partner with Mapiq to transform their new offices in both Zurich and Geneva into a great workplace. Mapiq leverages the existing Cisco CMX infrastructure to help employees with finding their colleagues and free places to work.



- KPMG, 6 offices Zurich and Geneva
- 2.000 employees
- Integration with Cisco CMX
- Improved employee experience with
 - Colleague finder
 - Workplace finder
 - Wayfinding

Thanks to Mapiq, employees are able to easily find their project members and available desk in the area. By leveraging the existing Cisco infrastructure we were able to deliver a complete solution within budget and with a positive ROI.



Unleash your office