

## Flyreel provides on-demand access to more and different data of a property's exterior, interior and contents for the P&C industry.

The data and reports generated by Flyreel create a baseline property record that supports core lifecycle activities from quote to underwriting to risk mitigation to claims to renewal.

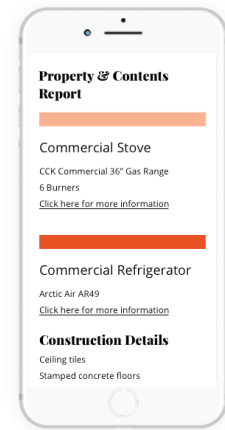
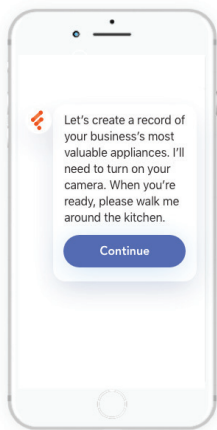

- **Our friendly, intuitive AI assistant adapts and guides end-users through inspections like your best expert would.**
- The workflow (type and number of questions) is highly configurable determined by each carriers' needs.
- Flyreel can be used prospective policyholders, policyholders, agents, brokers and/or inspectors.
- **Flyreel uses a proprietary insurance-specific computer vision technology to automatically document property contents, condition and more while guiding users through inspections.**
- The specific items and information documented are highly configurable, allowing carriers to capture high risk items.
- **Our detailed property and contents report provides access to new and enriched property data. Flyreel reports can be further enhanced through integration with other internal or third-party data sets.**
- Reports are accessible via Flyreel dashboard or easily integrated with carrier systems.

## Flyreel supports both commercial and personal lines providing a next generation user experience that agents and customers are seeking.

All that is needed is smart phone app (Apple or Android). Flyreel can be used as part of the quote or post-bind inspection process to provide more data, faster.